

Document Number	Document Revision	Document Revision Date	Product Date Code Beginning With
L4205	B	11/2017	A

NOTICE:

Enerpac recommends the installation of all parts included in a service assembly or repair kit to ensure optimum performance of the repaired product.

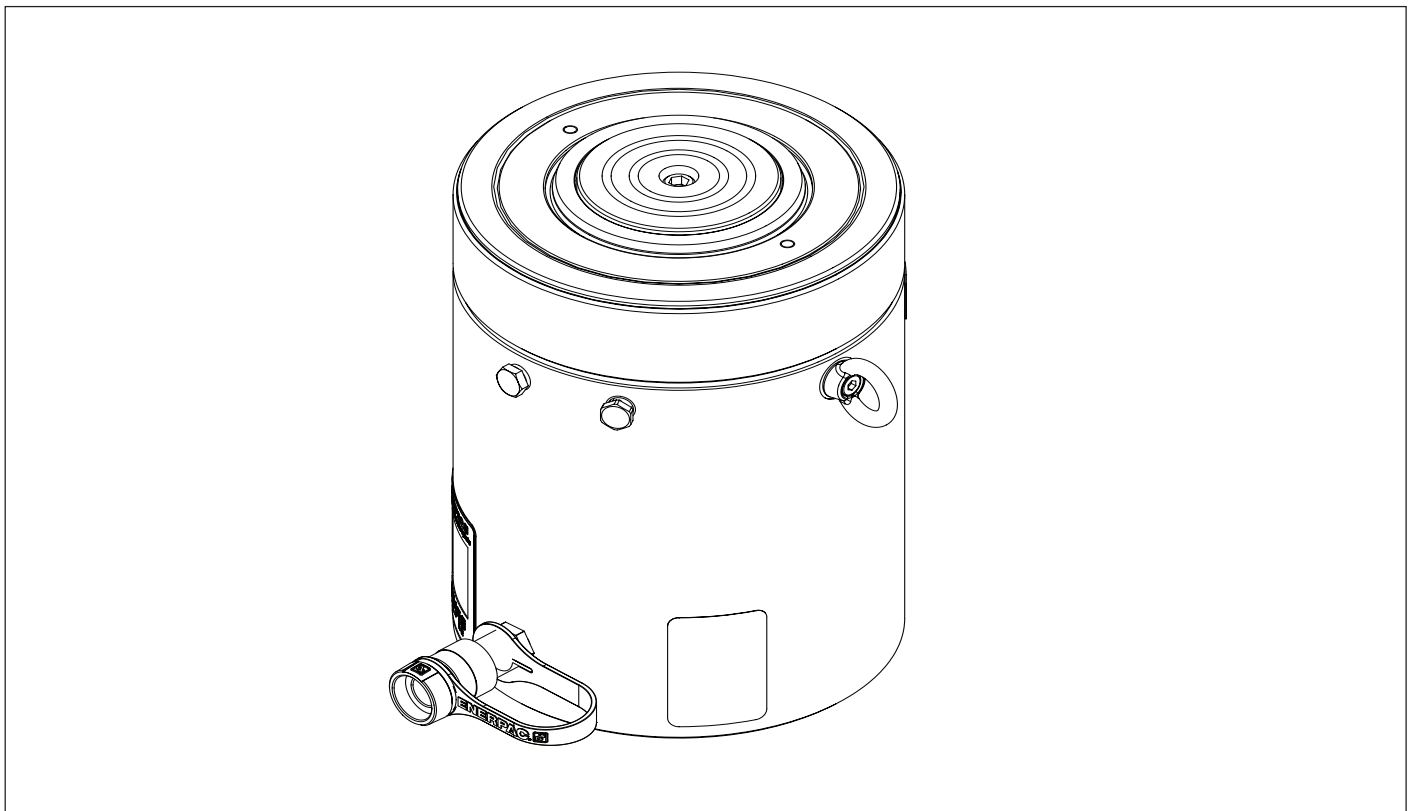
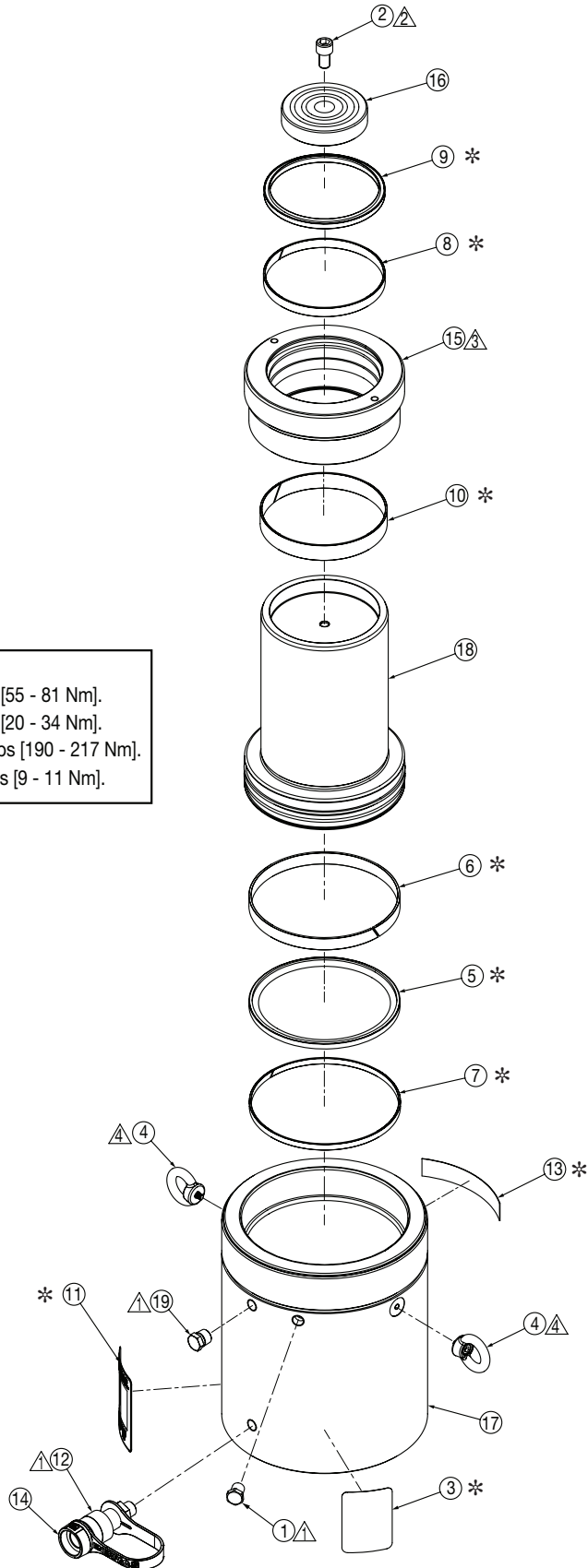

Table of Contents:

	Page		Page
Figure 1, Model HCG-250 Short	2-3	Figure 3, Model HCG-300	6-7
Figure 2, Model HCG-250 Tall	4-5	Figure 4, Model HCG-400	8-9

Figure 1, Exploded View - Model HCG-250 Short

- Notes:**
- ⚠ Torque to 40 - 60 ft-lbs [55 - 81 Nm].
 - ⚠ Torque to 15 - 25 ft-lbs [20 - 34 Nm].
 - ⚠ Torque to 140 - 160 ft-lbs [190 - 217 Nm].
 - ⚠ Torque to 80 - 100 in-lbs [9 - 11 Nm].



Repair Parts List for Figure 1			
Item	Part Number	Qty.	Description
1	BSS6349D	1	Plug
2	CBE1221028-1A	1	M12 x 20 Long SHCS
3	* DA5625026	1	Warning Decal, 2.19" x 3.18"
4	DB8050667	2	Eyebolt, Rotating, M8
5	* DB8079076	1	Piston Seal 215 x 194 x 8,1
6	* DB8081155	1	Bearing, Piston 215 x 15
7	* DB8082155	1	Bearing, Piston 215 x 9,7
8	* DB8083155	1	Bearing, Rod 170 x 15
9	* DB8085776	1	Wiper 170 mm
10	* DB8088155	1	Bearing, Rod 170 x 25
11	* DB8100026	1	Decal, Product Specification
12	CR400	1	Female Coupler
13	* DD1042026	1	Decal, Enerpac
14	CD411D	1	Dust Cap
15	HCG2502044	1	Stop Ring HCG 250 Ton Short
16	HCR250045	1	Saddle HCR 250 Ton
17	N/A	1	Base HCG/HCR 250 Ton 50 mm
	N/A	1	Base HCG/HCR 250 Ton 100 mm
	N/A	1	Base HCG/HCR 250 Ton 150 mm
18	HCR2502040	1	Plunger HCG/HCR 250 Ton 50 mm
	HCR2504040	1	Plunger HCG/HCR 250 Ton 100 mm
	HCR2506040	1	Plunger HCG/HCR 250 Ton 150 mm
19	R515245-2	1	Plug
* Included in HCG250K1 Seal Kit. N/A - Not Available			

Figure 2, Exploded View - Model HCG-250 Tall

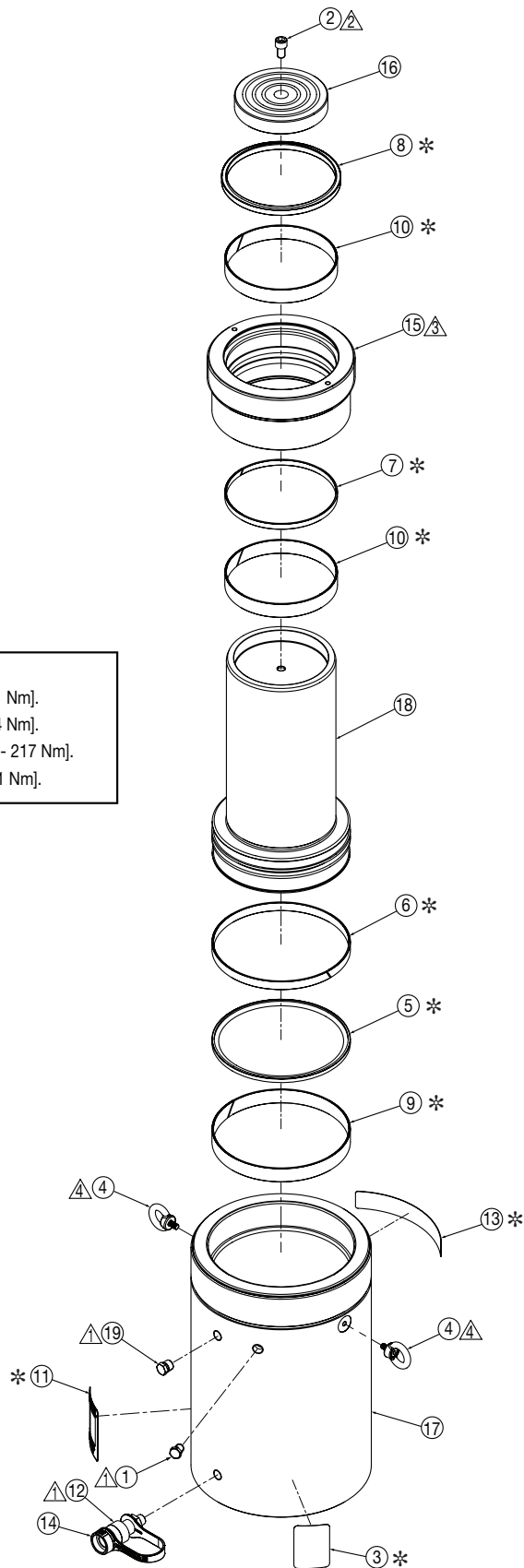

Notes:

- ① Torque to 40 - 60 ft-lbs [55 - 81 Nm].
- ② Torque to 15 - 25 ft-lbs [20 - 34 Nm].
- ③ Torque to 140 - 160 ft-lbs [190 - 217 Nm].
- ④ Torque to 80 - 100 in-lbs [9 - 11 Nm].

Repair Parts List for Figure 2			
Item	Part Number	Qty.	Description
1	BSS6349D	1	Plug
2	CBE1221028-1A	1	M12 x 20 Long SHCS
3	* DA5625026	1	Warning Decal, 2.19" x 3.18"
4	DB8050667	2	Eyebolt, Rotating, M8
5	* DB8079076	1	Piston Seal 215 x 194 x 8,1
6	* DB8081155	1	Bearing, Piston 215 x 15
7	* DB8084155	1	Bearing, Rod 170 x 9,7
8	* DB8085776	1	Wiper 170 mm
9	* DB8087155	1	Bearing, Piston 215 x 25
10	* DB8088155	2	Bearing, Rod 170 x 25
11	* DB8100026	1	Decal, Product Specification
12	CR400	1	Female Coupler
13	* DD1042026	1	Decal, Enerpac
14	CD411D	1	Dust Cap
15	HCG2508044	1	Stop Ring HCG 250 Ton Tall
16	HCR250045	1	Saddle HCR 250 Ton
17	N/A	1	Base HCG/HCR 250 Ton 200 mm
	N/A	1	Base HCG/HCR 250 Ton 250 mm
	N/A	1	Base HCG/HCR 250 Ton 300 mm
18	HCR2508040	1	Plunger HCG/HCR 250 Ton 200 mm
	HCR25010040	1	Plunger HCG/HCR 250 Ton 250 mm
	HCR25012040	1	Plunger HCG/HCR 250 Ton 300 mm
19	R515245-2	1	Plug
* Included in HCG250K2 Seal Kit. N/A - Not Available			

Figure 3, Exploded View - Model HCG-300

- Notes:**
- ⚠️ Torque to 40 - 60 ft-lbs [55 - 81 Nm].
 - ⚠️ Torque to 15 - 25 ft-lbs [20 - 34 Nm].
 - ⚠️ Torque to 140 - 160 ft-lbs [190 - 217 Nm].
 - ⚠️ Torque to 80 - 100 in-lbs [9 - 11 Nm].

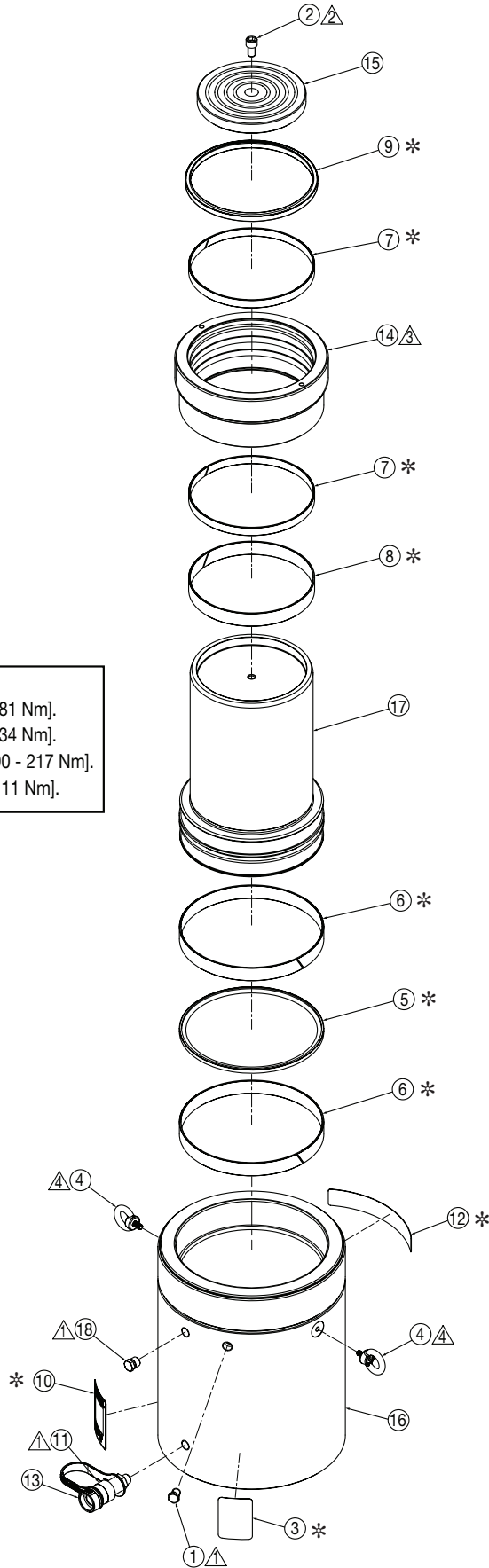

Repair Parts List for Figure 3

Item	Part Number	Qty.	Description
1	BSS6349D	1	Plug
2	CBE1221028-1A	1	M12 x 20 Long SHCS
3	* DA5625026	1	Warning Decal, 2.19" x 3.18"
4	DB8050667	2	Eyebolt, Rotating, M8
5	* DB8089076	1	Piston Seal 235 x 214 x 8,1
6	* DB8091155	2	Bearing, Piston 235 x 25
7	* DB8092155	2	Bearing, Rod 200 x 15
8	* DB8093155	1	Bearing, Rod 200 x 25
9	* DB8094776	1	Wiper 200 mm
10	* DB8100026	1	Decal, Product Specification
11	CR400	1	Female Coupler
12	* DD1042026	1	Decal, Enerpac
13	CD411D	1	Dust Cap
14	HCG3002044	1	Stop Ring HCG 300 Ton
15	HCR300045	1	Saddle HCR 300 Ton
16	N/A	1	Base HCG/HCR 300 Ton 50 mm
	N/A	1	Base HCG/HCR 300 Ton 100 mm
	N/A	1	Base HCG/HCR 300 Ton 150 mm
	N/A	1	Base HCG/HCR 300 Ton 200 mm
	N/A	1	Base HCG/HCR 300 Ton 250 mm
	N/A	1	Base HCG/HCR 300 Ton 300 mm
17	HCR3002040	1	Plunger HCG/HCR 300 Ton 50 mm
	HCR3004040	1	Plunger HCG/HCR 300 Ton 100 mm
	HCR3006040	1	Plunger HCG/HCR 300 Ton 150 mm
	HCR3008040	1	Plunger HCG/HCR 300 Ton 200 mm
	HCR30010040	1	Plunger HCG/HCR 300 Ton 250 mm
	HCR30012040	1	Plunger HCG/HCR 300 Ton 300 mm
18	R515245-2	1	Plug
* Included in HCG300K Seal Kit. N/A - Not Available			

Figure 4, Exploded View - Model HCG-400

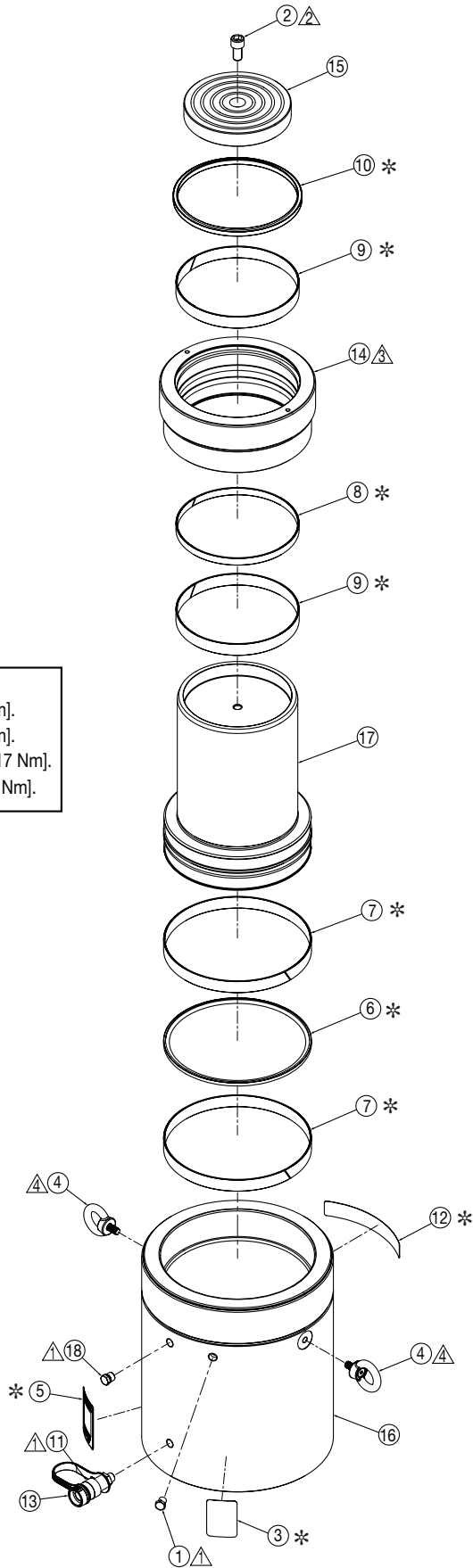

Notes:

- \triangle Torque to 40 - 60 ft-lbs [55 - 81 Nm].
- \triangle Torque to 30 - 40 ft-lbs [41 - 54 Nm].
- \triangle Torque to 140 - 160 ft-lbs [190 - 217 Nm].
- \triangle Torque to 200 - 240 in-lbs [23 - 27 Nm].

Repair Parts List for Figure 4

Item	Part Number	Qty.	Description
1	BSS6349D	1	Plug
2	CBE1625028-1A	1	Screw, SHC M16 x 30 Zinc
3	* DA5625026	1	Warning Decal, 2.19" x 3.18"
4	DB8086667	2	Eyebolt, Rotating, M12
5	* DB8100026	1	Decal, Product Specification
6	* DB8140076	1	Piston Seal 270 x 249 x 8,1
7	* DB8142155	2	Bearing, Piston 270 x 25
8	* DB8143155	1	Bearing, Rod 220 x 15
9	* DB8144155	2	Bearing, Rod 220 x 25
10	* DB8145776	1	Wiper 220 mm
11	CR400	1	Female Coupler
12	* DD1042026	1	Decal, Enerpac
13	CD411D	1	Dust Cap
14	HCG4002044	1	Stop Ring HCG 400 Ton
15	HCR400045	1	Saddle HCR 400 Ton
16	N/A	1	Base HCG/HCR 400 Ton 50 mm
	N/A	1	Base HCG/HCR 400 Ton 100 mm
	N/A	1	Base HCG/HCR 400 Ton 150 mm
	N/A	1	Base HCG/HCR 400 Ton 200 mm
	N/A	1	Base HCG/HCR 400 Ton 250 mm
	N/A	1	Base HCG/HCR 400 Ton 300 mm
17	HCR4002040	1	Plunger HCG/HCR 400 Ton 50 mm
	HCR4004040	1	Plunger HCG/HCR 400 Ton 100 mm
	HCR4006040	1	Plunger HCG/HCR 400 Ton 150 mm
	HCR4008040	1	Plunger HCG/HCR 400 Ton 200 mm
	HCR40010040	1	Plunger HCG/HCR 400 Ton 250 mm
	HCR40012040	1	Plunger HCG/HCR 400 Ton 300 mm
18	R515245-2	1	Plug

* Included in HCG400K Seal Kit. N/A - Not Available

NOTES:

<hr/> <hr/> <hr/> <hr/> <hr/> <hr/> <hr/> <hr/> <hr/> <hr/> <hr/> <hr/> <hr/> <hr/> <hr/> <hr/> <hr/> <hr/> <hr/> <hr/> <hr/> <hr/> <hr/> <hr/> <hr/> <hr/> <hr/> <hr/> <hr/>

NOTES:

A large rectangular area containing 21 horizontal lines, intended for writing notes.

