

Document Number	Document Revision	Document Revision Date	Product Date Code Beginning With
L4209	B	11/2017	A

NOTICE:

Enerpac recommends the installation of all parts included in a service assembly or repair kit to ensure optimum performance of the repaired product.

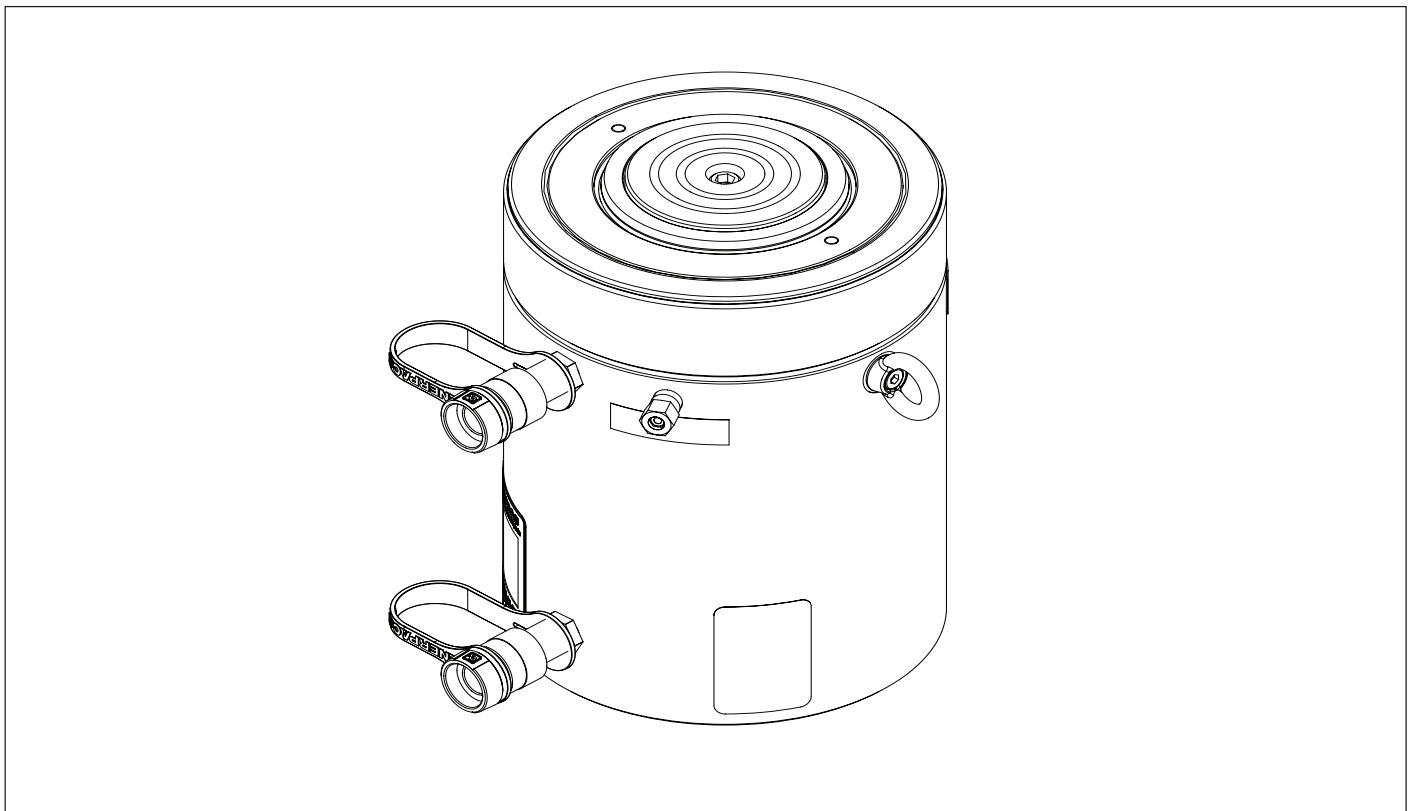





Table of Contents:

	Page		Page
Figure 1, Model HCR-250 Short	2-3	Figure 3, Model HCR-300	6-7
Figure 2, Model HCR-250 Tall	4-5	Figure 4, Model HCR-400	8-9

Figure 1, Exploded View - Model HCR-250 Short

Notes:

-  Torque to 40 - 60 ft-lbs [55 - 81 Nm].
-  Torque to 15 - 25 ft-lbs [20 - 34 Nm].
-  Torque to 140 - 160 ft-lbs [190 - 217 Nm].
-  Torque to 80 - 100 in-lbs [9 - 11 Nm].

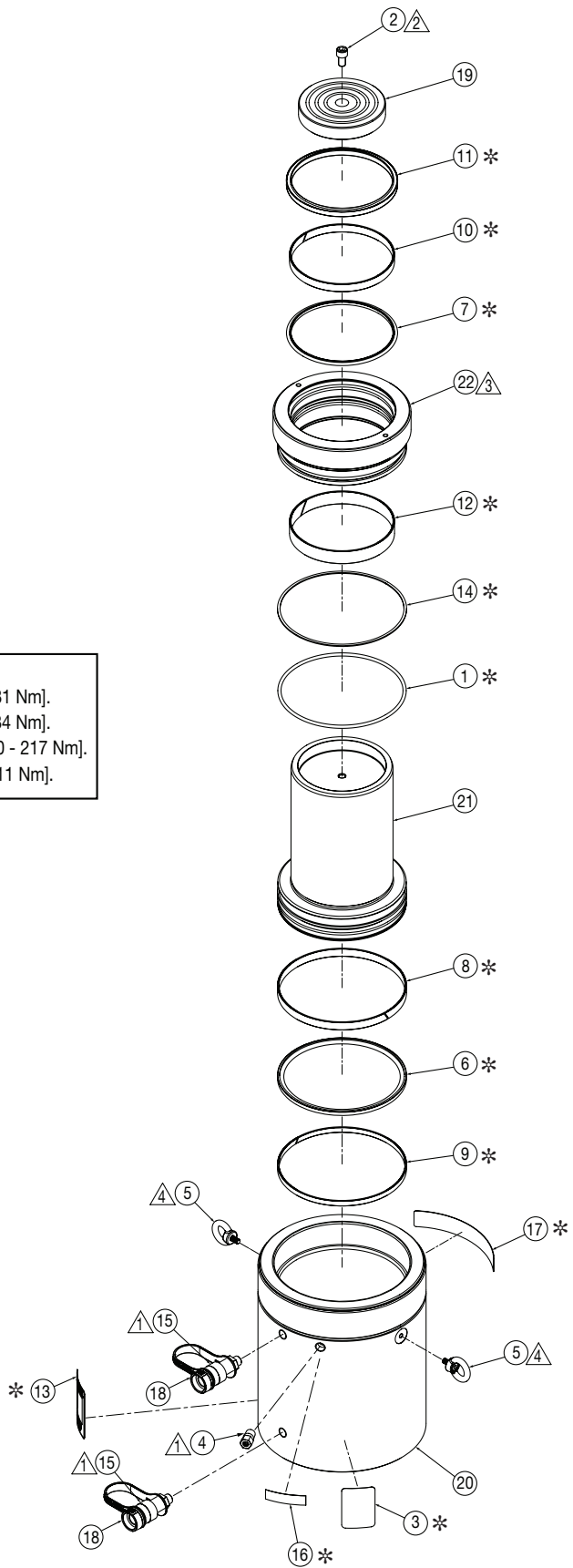

Repair Parts List for Figure 1

Item	Part Number	Qty.	Description
1	* B1371503	1	O-Ring 202,57 x 5,33 Dash 369
2	CBE1221028-1A	1	M12 x 20 Long SHCS
3	* DA5625026	1	Warning Decal, 2.19" x 3.18"
4	DB8049900	1	Relief Valve Assembly
5	DB8050667	2	Eyebolt, Rotating, M8
6	* DB8079076	1	Piston Seal 125 x 194 x 8,1
7	* DB8080076	1	Rod Seal 170 x 185,1 x 6,3
8	* DB8081155	1	Bearing, Piston 215 x 15
9	* DB8082155	1	Bearing, Piston 215 x 9,7
10	* DB8083155	1	Bearing, Rod 170 x 25
11	* DB8085776	1	Wiper 170 mm
12	* DB8088155	1	Bearing, Rod 170 x 25
13	* DB8100026	1	Decal, Product Specification
14	* DB8127565	1	Back Up Ring 215 x 206,4 x 1,7
15	CR400	2	Female Coupler
16	* DC6154026	1	Decal, Safety Warning
17	* DD1042026	1	Decal, Enerpac
18	CD411D	2	Dust Cap
19	HCR250045	1	Saddle HCR 250 Ton
20	N/A	1	Base HCG/HCR 250 Ton 50 mm
	N/A	1	Base HCG/HCR 250 Ton 100 mm
	N/A	1	Base HCG/HCR 250 Ton 150 mm
21	HCR2502040	1	Plunger HCG/HCR 250 Ton 50 mm
	HCR2504040	1	Plunger HCG/HCR 250 Ton 100 mm
	HCR2506040	1	Plunger HCG/HCR 250 Ton 150 mm
22	HCR2502044	1	Stop Ring HCG/HCR 250 Ton Short
* Included in HCR250K1 Seal Kit. N/A - Not Available.			

Figure 2, Exploded View - Model HCR-250 Tall

- Notes:**
- ⚠ Torque to 40 - 60 ft-lbs [55 - 81 Nm].
 - ⚠ Torque to 15 - 25 ft-lbs [20 - 34 Nm].
 - ⚠ Torque to 140 - 160 ft-lbs [190 - 217 Nm].
 - ⚠ Torque to 80 - 100 in-lbs [9 - 11 Nm].

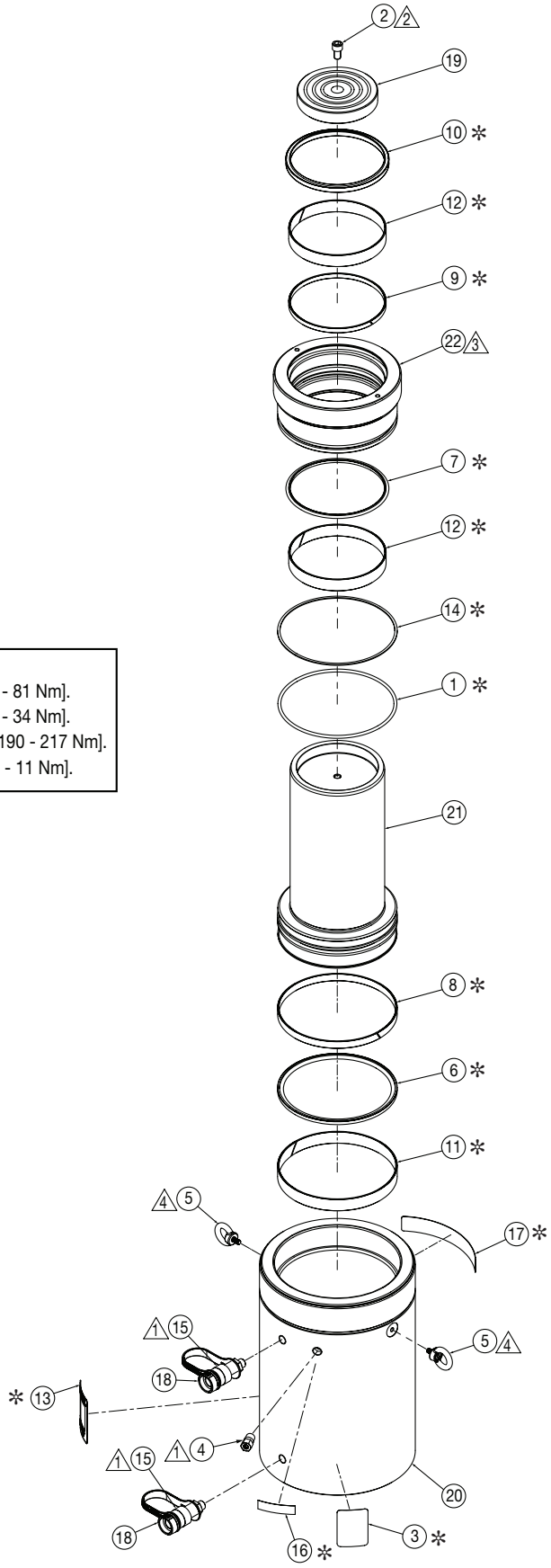

Repair Parts List for Figure 2

Item	Part Number	Qty.	Description
1	* B1371503	1	O-Ring 202,57 x 5,33 Dash 369
2	CBE1221028-1A	1	M12 x 20 Long SHCS
3	* DA5625026	1	Warning Decal, 2.19" x 3.18"
4	DB8049900	1	Relief Valve Assembly
5	DB8050667	2	Eyebolt, Rotating, M8
6	* DB8079076	1	Piston Seal 170 x 185,1 x 6,3
7	* DB8080076	1	Rod Seal 170 x 185,1 x 6,3
8	* DB8081155	1	Bearing, Piston 215 x 15
9	* DB8084155	1	Bearing, Rod 170 x 9,7
10	* DB8085776	1	Wiper 170 mm
11	* DB8087155	1	Bearing, Piston 215 x 25
12	* DB8088155	2	Bearing, Rod 170 x 25
13	* DB8100026	1	Decal, Product Specification
14	* DB8127565	1	Back Up Ring 215 x 206,4 x 1,7
15	CR400	2	Female Coupler
16	* DC6154026	1	Decal, Safety Warning
17	* DD1042026	1	Decal, Enerpac
18	CD411D	2	Dust Cap
19	HCR250045	1	Saddle HCR 250 Ton
20	N/A	1	Base HCG/HCR 250 Ton 200 mm
	N/A	1	Base HCG/HCR 250 Ton 250 mm
	N/A	1	Base HCG/HCR 250 Ton 300 mm
21	HCR2508040	1	Plunger HCG/HCR 250 Ton 200 mm
	HCR25010040	1	Plunger HCG/HCR 250 Ton 250 mm
	HCR25012040	1	Plunger HCG/HCR 250 Ton 300 mm
22	HCR2508044	1	Stop Ring HCG/HCR 250 Ton Tall
* Included in HCR250K2 Seal Kit. N/A - Not Available.			

Figure 3, Exploded View - Model HCR-300

- Notes:**
- ⚠ Torque to 40 - 60 ft-lbs [55 - 81 Nm].
 - ⚠ Torque to 15 - 25 ft-lbs [20 - 34 Nm].
 - ⚠ Torque to 140 - 160 ft-lbs [190 - 217 Nm].
 - ⚠ Torque to 80 - 100 in-lbs [9 - 11 Nm].

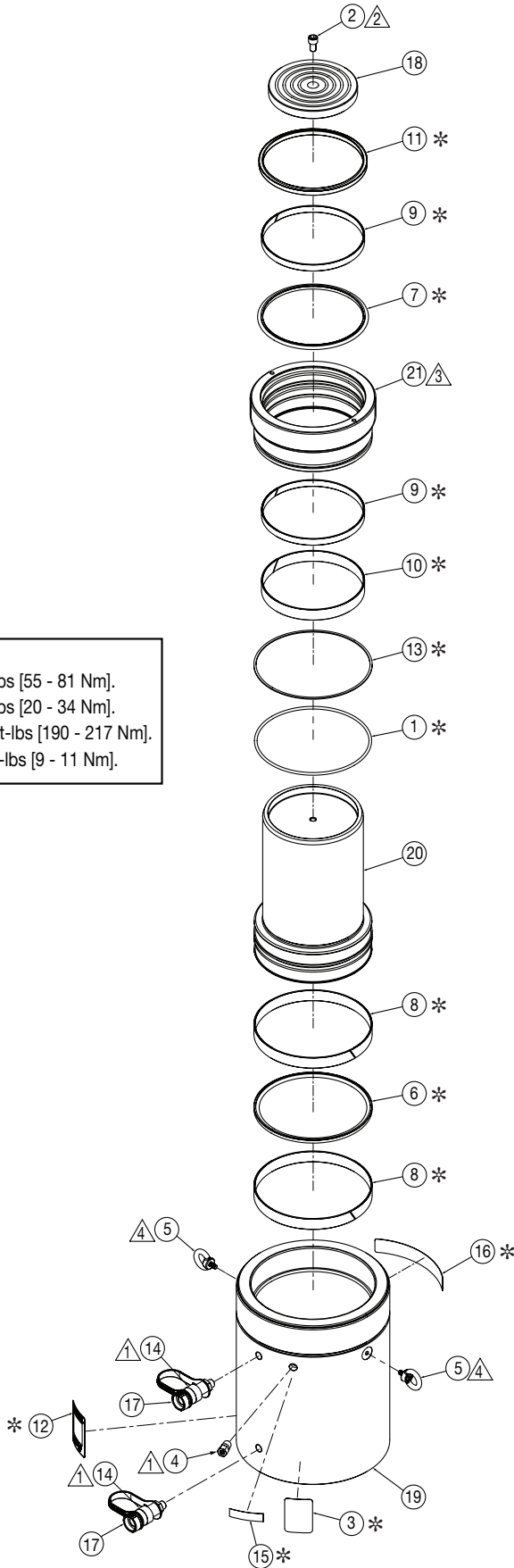

Repair Parts List for Figure 3

Item	Part Number	Qty.	Description
1	* B1374503	1	O-Ring 221,62 x 5,33 Dash 372
2	CBE1221028-1A	1	M12 x 20 Long SHCS
3	* DA5625026	1	Warning Decal, 2.19" x 3.18"
4	DB8049900	1	Relief Valve Assembly
5	DB8050667	2	Eyebolt, Rotating, M8
6	* DB8089076	1	Piston Seal 235 x 214 x 8,1
7	* DB8090076	1	Rod Seal 200 x 220,5 x 8,1
8	* DB8091155	2	Bearing, Piston 235 x 25
9	* DB8092155	2	Bearing, Rod 200 x 15
10	* DB8093155	1	Bearing, Rod 200 x 25
11	* DB8094776	1	Wiper 200 mm
12	* DB8100026	1	Decal, Product Specification
13	* DB8129565	1	Back Up Ring 235 x 226,4 x 1,7
14	CR400	2	Female Coupler
15	* DC6154026	1	Decal, Safety Warning
16	* DD1042026	1	Decal, Enerpac
17	CD411D	2	Dust Cap
18	HCR300045	1	Saddle HCR 300 Ton
19	N/A	1	Base HCG/HCR 300 Ton 50 mm
	N/A	1	Base HCG/HCR 300 Ton 100 mm
	N/A	1	Base HCG/HCR 300 Ton 150 mm
	N/A	1	Base HCG/HCR 300 Ton 200 mm
	N/A	1	Base HCG/HCR 300 Ton 250 mm
	N/A	1	Base HCG/HCR 300 Ton 300 mm
20	HCR3002040	1	Plunger HCG/HCR 300 Ton 50 mm
	HCR3004040	1	Plunger HCG/HCR 300 Ton 100 mm
	HCR3006040	1	Plunger HCG/HCR 300 Ton 150 mm
	HCR3008040	1	Plunger HCG/HCR 300 Ton 200 mm
	HCR30010040	1	Plunger HCG/HCR 300 Ton 250 mm
	HCR30012040	1	Plunger HCG/HCR 300 Ton 300 mm
21	HCR3002044	1	Stop Ring HCR 300 Ton
* Included in HCR300K Seal Kit. N/A - Not Available.			

Figure 4, Exploded View - Model HCR-400

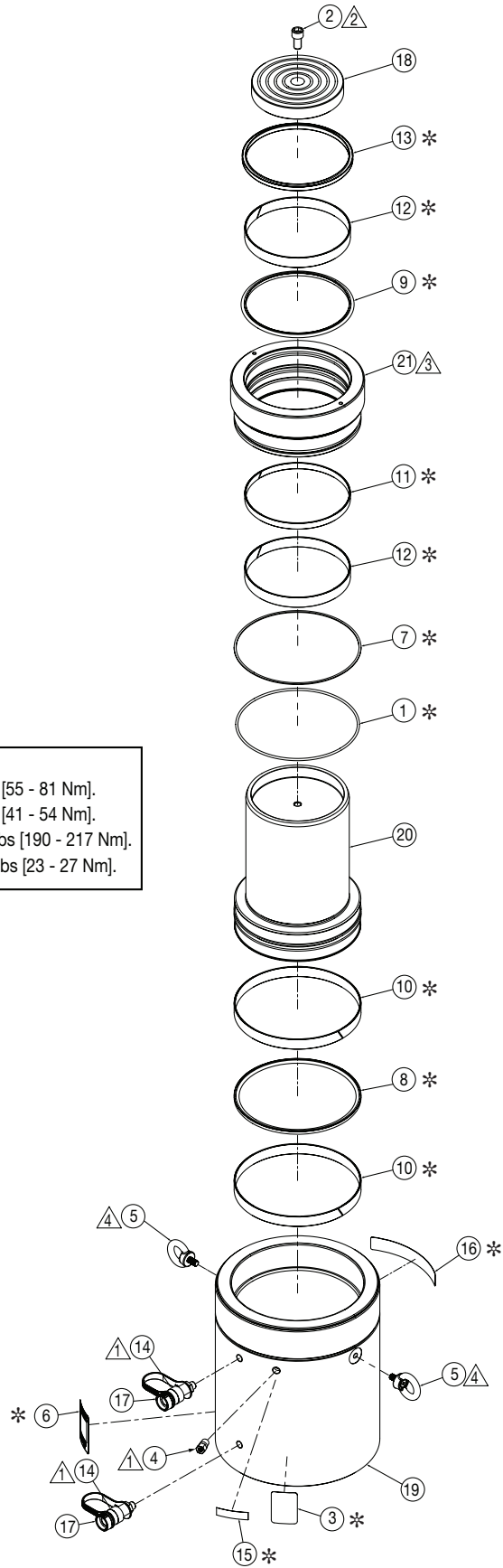

Notes:

- ▲ Torque to 40 - 60 ft-lbs [55 - 81 Nm].
- ▲ Torque to 30 - 40 ft-lbs [41 - 54 Nm].
- ▲ Torque to 140 - 160 ft-lbs [190 - 217 Nm].
- ▲ Torque to 200 - 240 in-lbs [23 - 27 Nm].

Repair Parts List for Figure 4

Item	Part Number	Qty.	Description
1	* B1379503	1	O-Ring 253,37 x 5,33 Dash 377
2	CBE1625028-1A	1	Screw SHC M16 x 30 Zinc
3	* DA5625026	1	Warning Decal, 2.19" x 3.18"
4	DB8049900	1	Relief Valve Assembly
5	DB8086667	2	Eyebolt, Rotating, M12
6	* DB8100026	1	Decal, Product Specification
7	* DB8131565	1	Back Up Ring 270 x 261,4 x 1,7
8	* DB8140076	1	Piston Seal 270 x 249 x 8,1
9	* DB8141076	1	Rod Seal 220 x 240,5 x 8,1
10	* DB8142155	2	Bearing, Piston 270 x 25
11	* DB8143155	1	Bearing, Rod 220 x 15
12	* DB8144155	2	Bearing, Rod 220 x 25
13	* DB8145776	1	Wiper 220 mm
14	CR400	2	Female Coupler
15	* DC6154026	1	Decal, Safety Warning
16	* DD1042026	1	Decal, Enerpac
17	CD411D	2	Dust Cap
18	HCR400045	1	Saddle HCR 400 Ton
19	N/A	1	Base HCG/HCR 400 Ton 50 mm
	N/A	1	Base HCG/HCR 400 Ton 100 mm
	N/A	1	Base HCG/HCR 400 Ton 150 mm
	N/A	1	Base HCG/HCR 400 Ton 200 mm
	N/A	1	Base HCG/HCR 400 Ton 250 mm
	N/A	1	Base HCG/HCR 400 Ton 300 mm
20	HCR4002040	1	Plunger HCG/HCR 400 Ton 50 mm
	HCR4004040	1	Plunger HCG/HCR 400 Ton 100 mm
	HCR4006040	1	Plunger HCG/HCR 400 Ton 150 mm
	HCR4008040	1	Plunger HCG/HCR 400 Ton 200 mm
	HCR40010040	1	Plunger HCG/HCR 400 Ton 250 mm
	HCR40012040	1	Plunger HCG/HCR 400 Ton 300 mm
21	HCR4002044	1	Stop Ring HCR 400 Ton
* Included in HCR400K Seal Kit. N/A - Not Available.			

