

Document Number	Document Revision	Document Revision Date	Product Date Code Beginning With
L4210	B	11/2017	A

**NOTICE:**

Enerpac recommends the installation of all parts included in a service assembly or repair kit to ensure optimum performance of the repaired product.

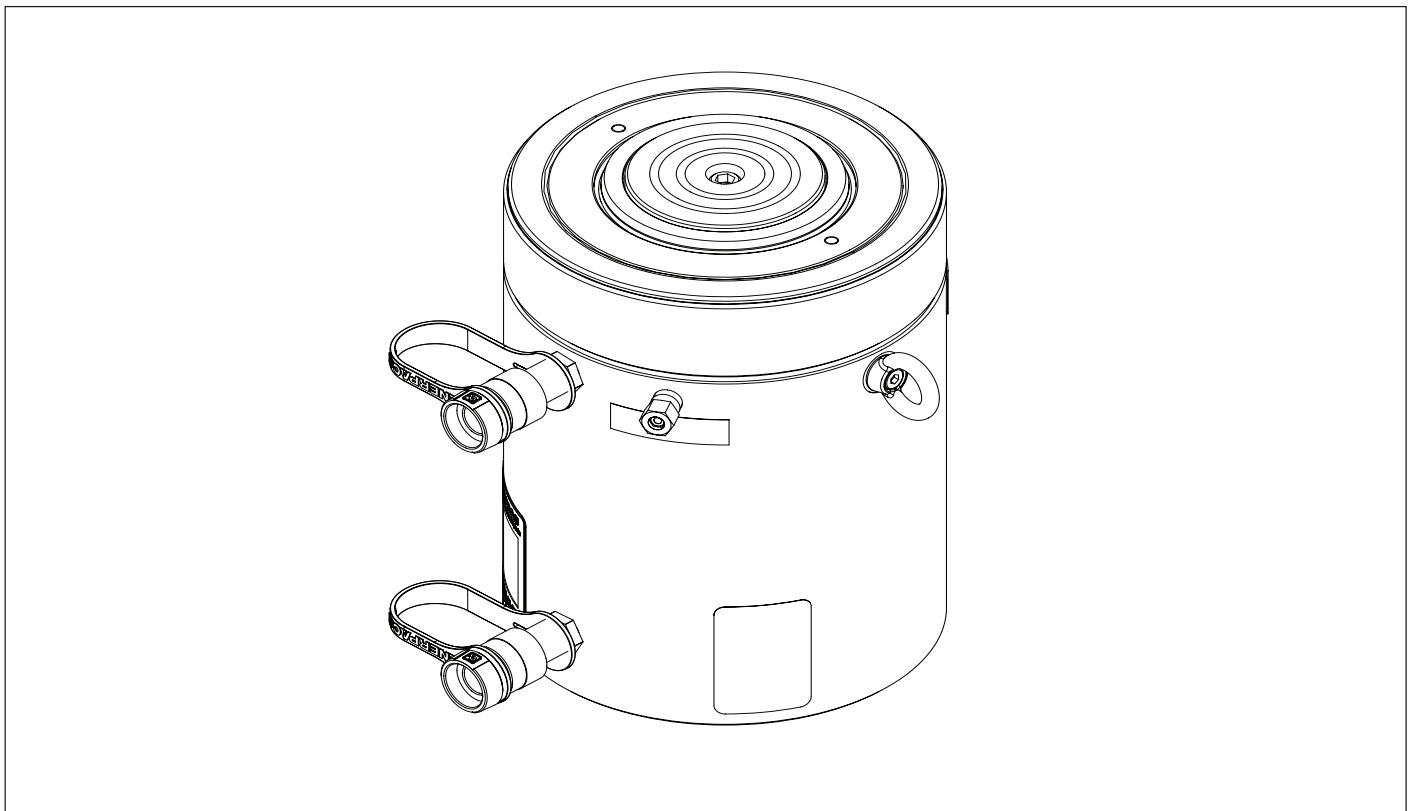
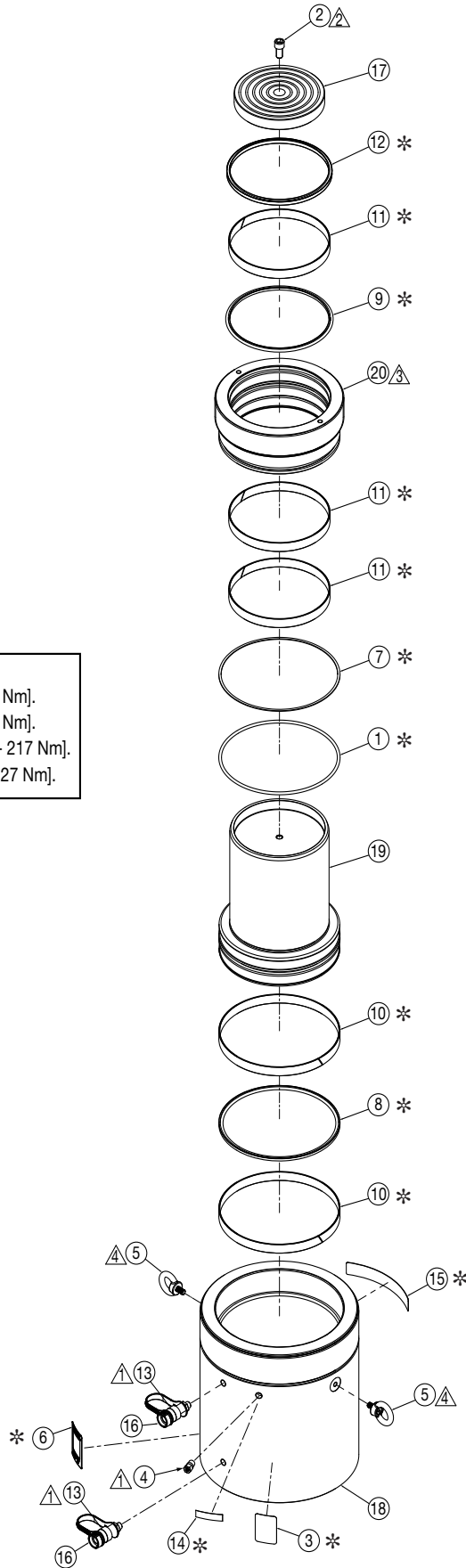

**Table of Contents:**

	Page		Page
Figure 1, Model HCR-500 .....	2-3	Figure 3, Model HCR-800 .....	6-7
Figure 2, Model HCR-600 .....	4-5	Figure 4, Model HCR-1000 .....	8-9

**Figure 1, Exploded View - Model HCR-500**

- Notes:**
- ⚠ Torque to 40 - 60 ft-lbs [55 - 81 Nm].
  - ⚠ Torque to 30 - 40 ft-lbs [41 - 54 Nm].
  - ⚠ Torque to 140 - 160 ft-lbs [190 - 217 Nm].
  - ⚠ Torque to 200 - 240 in-lbs [23 - 27 Nm].



**Repair Parts List for Figure 1**

<b>Item</b>	<b>Part Number</b>	<b>Qty.</b>	<b>Description</b>
1	* B1079503	1	O-Ring 291,47 x 7,00 Dash 452
2	CBE1625028-1A	1	Screw, SHC M16 x 30 Zinc
3	* DA5625026	1	Warning Decal, 2.19" x 3.18"
4	DB8049900	1	Relief Valve Assembly
5	DB8086667	2	Eyebolt, Rotating, M12
6	* DB8100026	1	Decal, Product Specification
7	* DB8133565	1	Back Up Ring 305 x 293,4 x 1,7
8	* DB8146076	1	Piston Seal 305 x 284 x 8,1
9	* DB8147076	1	Rod Seal 250 x 270,5 x 8,1
10	* DB8148155	2	Bearing, Piston 305 x 25
11	* DB8149155	3	Bearing, Rod 250 x 25
12	* DB8150776	1	Wiper 250 mm
13	CR400	2	Female Coupler
14	* DC6154026	1	Decal, Safety Warning
15	* DC9596026	1	Decal, Enerpac
16	CD411D	2	Dust Cap
17	HCR500045	1	Saddle HCR 500 Ton
18	N/A	1	Base HCG/HCR 500 Ton 50 mm
	N/A	1	Base HCG/HCR 500 Ton 100 mm
	N/A	1	Base HCG/HCR 500 Ton 150 mm
	N/A	1	Base HCG/HCR 500 Ton 200 mm
	N/A	1	Base HCG/HCR 500 Ton 250 mm
	N/A	1	Base HCG/HCR 500 Ton 300 mm
19	HCR5002040	1	Plunger HCG/HCR 500 Ton 50 mm
	HCR5004040	1	Plunger HCG/HCR 500 Ton 100 mm
	HCR5006040	1	Plunger HCG/HCR 500 Ton 150 mm
	HCR5008040	1	Plunger HCG/HCR 500 Ton 200 mm
	HCR50010040	1	Plunger HCG/HCR 500 Ton 250 mm
	HCR50012040	1	Plunger HCG/HCR 500 Ton 300 mm
20	HCR5002044	1	Stop Ring HCR 500 Ton

\* Included in HCR500K Seal Kit. N/A - Not Available.

**Figure 2, Exploded View - Model HCR-600**

- Notes:**
- ▲ Torque to 40 - 60 ft-lbs [55 - 81 Nm].
  - ▲ Torque to 30 - 40 ft-lbs [41 - 54 Nm].
  - ▲ Torque to 140 - 160 ft-lbs [190 - 217 Nm].
  - ▲ Torque to 200 - 240 in-lbs [23 - 27 Nm].

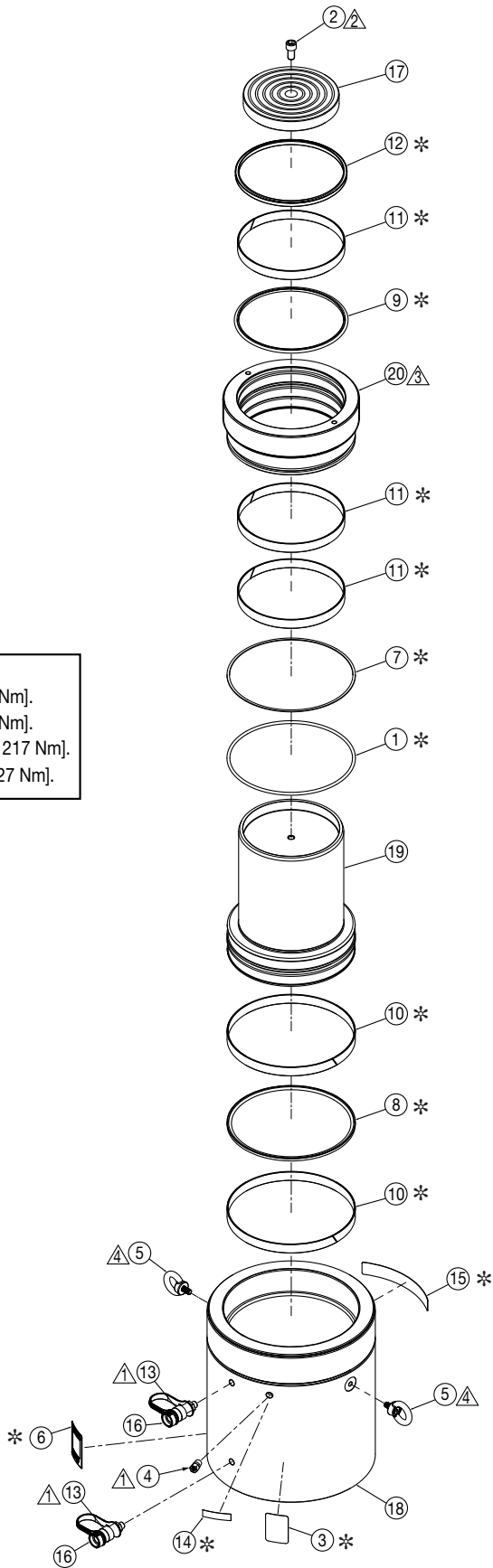

**Repair Parts List for Figure 2**

<b>Item</b>	<b>Part Number</b>	<b>Qty.</b>	<b>Description</b>
1	* B1080503	1	O-Ring 304,17 x 7,00 Dash 453
2	CBE1625028-1A	1	Screw, SHC M16 x 30 Zinc
3	* DA5625026	1	Warning Decal, 2.19" x 3.18"
4	DB8049900	1	Relief Valve Assembly
5	DB8086667	2	Eyebolt, Rotating, M12
6	* DB8100026	1	Decal, Product Specification
7	* DB8135565	1	Back Up Ring 330 x 318,4 x 1,7
8	* DB8151076	1	Piston, Seal 330 x 305,5 x 8,1
9	* DB8152076	1	Rod, Seal 270 x 294 8,1
10	* DB8153155	2	Bearing, Piston 330 x 25
11	* DB8154155	3	Bearing, Rod 270 x 25
12	* DB8155776	1	Wiper 270 mm
13	CR400	2	Female Coupler
14	* DC6154026	1	Decal, Safety Warning
15	* DC9596026	1	Decal, Enerpac
16	CD411D	2	Dust Cap
17	HCR600045	1	Saddle HCR 600 Ton
18	N/A	1	Base HCG/HCR 600 Ton 50 mm
	N/A	1	Base HCG/HCR 600 Ton 100 mm
	N/A	1	Base HCG/HCR 600 Ton 150 mm
	N/A	1	Base HCG/HCR 600 Ton 200 mm
	N/A	1	Base HCG/HCR 600 Ton 250 mm
	N/A	1	Base HCG/HCR 600 Ton 300 mm
19	HCR6002040	1	Plunger HCG/HCR 600 Ton 50 mm
	HCR6004040	1	Plunger HCG/HCR 600 Ton 100 mm
	HCR6006040	1	Plunger HCG/HCR 600 Ton 150 mm
	HCR6008040	1	Plunger HCG/HCR 600 Ton 200 mm
	HCR60010040	1	Plunger HCG/HCR 600 Ton 250 mm
	HCR60012040	1	Plunger HCG/HCR 600 Ton 300 mm
20	HCR6002044	1	Stop Ring HCR 600 Ton

\* Included in HCR600K Seal Kit. N/A - Not Available.

**Figure 3, Exploded View - Model HCR-800**

- Notes:**
- ⚠ Torque to 40 - 60 ft-lbs [55 - 81 Nm].
  - ⚠ Torque to 30 - 40 ft-lbs [41 - 54 Nm].
  - ⚠ Torque to 140 - 160 ft-lbs [190 - 217 Nm].
  - ⚠ Torque to 240 - 290 in-lbs [27 - 33 Nm].

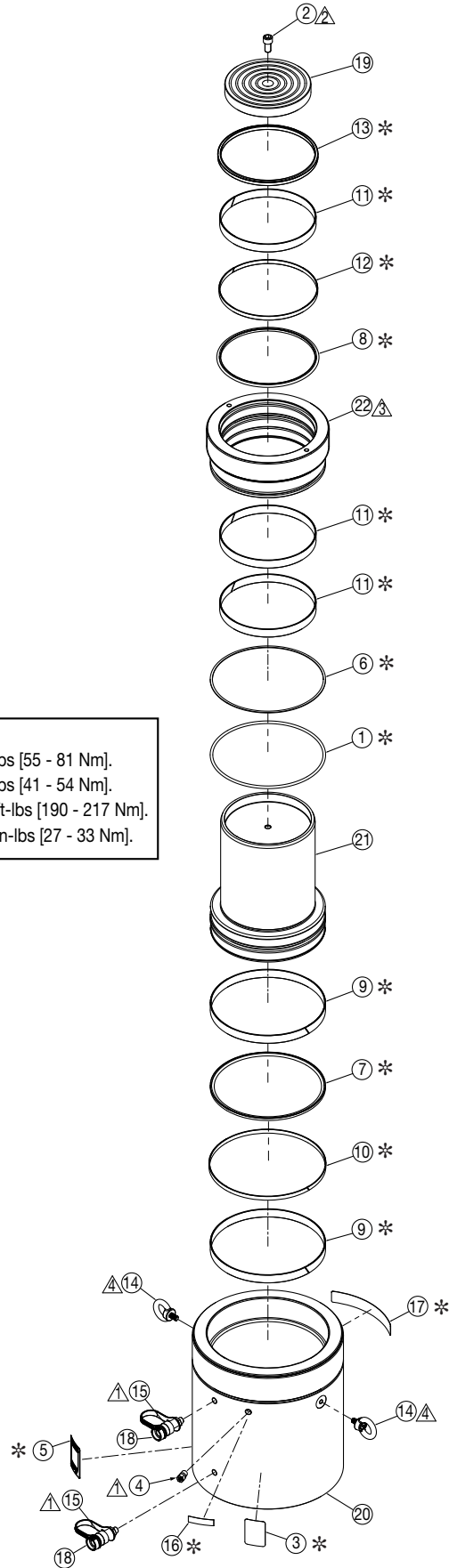

**Repair Parts List for Figure 3**

<b>Item</b>	<b>Part Number</b>	<b>Qty.</b>	<b>Description</b>
1	* B1419503	1	O-Ring 367,67 x 7,00 Dash 458
2	CBE1625028-1A	1	Screw, SHC M16 x 30 Zinc
3	* DA5625026	1	Warning Decal, 2.19" x 3.18"
4	DB8049900	1	Relief Valve Assembly
5	* DB8100026	1	Decal, Product Specification
6	* DB8137565	1	Back Up Ring 385 x 373,4 x 1,7
7	* DB8156076	1	Piston Seal 385 x 360,5 x 8,1
8	* DB8157076	1	Rod Seal 320 x 344 x 8,1
9	* DB8158155	2	Bearing, Piston 385 x 25
10	* DB8159155	1	Bearing, Piston 385 x 15
11	* DB8160155	3	Bearing, Rod 320 x 25
12	* DB8161155	1	Bearing, Rod 320 x 15
13	* DB8162776	1	Wiper 320 mm
14	DB8168667	2	Eyebolt, Rotating, M14
15	CR400	2	Female Coupler
16	* DC6154026	1	Decal, Safety Warning
17	* DC9596026	1	Decal, Enerpac
18	CD411D	2	Dust Cap
19	HCR800045	1	Saddle HCR 800 Ton
20	N/A	1	Base HCG/HCR 800 Ton 50 mm
	N/A	1	Base HCG/HCR 800 Ton 100 mm
	N/A	1	Base HCG/HCR 800 Ton 150 mm
	N/A	1	Base HCG/HCR 800 Ton 200 mm
	N/A	1	Base HCG/HCR 800 Ton 250 mm
	N/A	1	Base HCG/HCR 800 Ton 300 mm
21	HCR8002040	1	Plunger HCG/HCR 800 Ton 50 mm
	HCR8004040	1	Plunger HCG/HCR 800 Ton 100 mm
	HCR8006040	1	Plunger HCG/HCR 800 Ton 150 mm
	HCR8008040	1	Plunger HCG/HCR 800 Ton 200 mm
	HCR80010040	1	Plunger HCG/HCR 800 Ton 250 mm
	HCR80012040	1	Plunger HCG/HCR 800 Ton 300 mm
22	HCR8002044	1	Stop Ring HCR 800 Ton
* Included in HCR800K Seal Kit. N/A - Not Available.			

**Figure 4, Exploded View - Model HCR-1000**

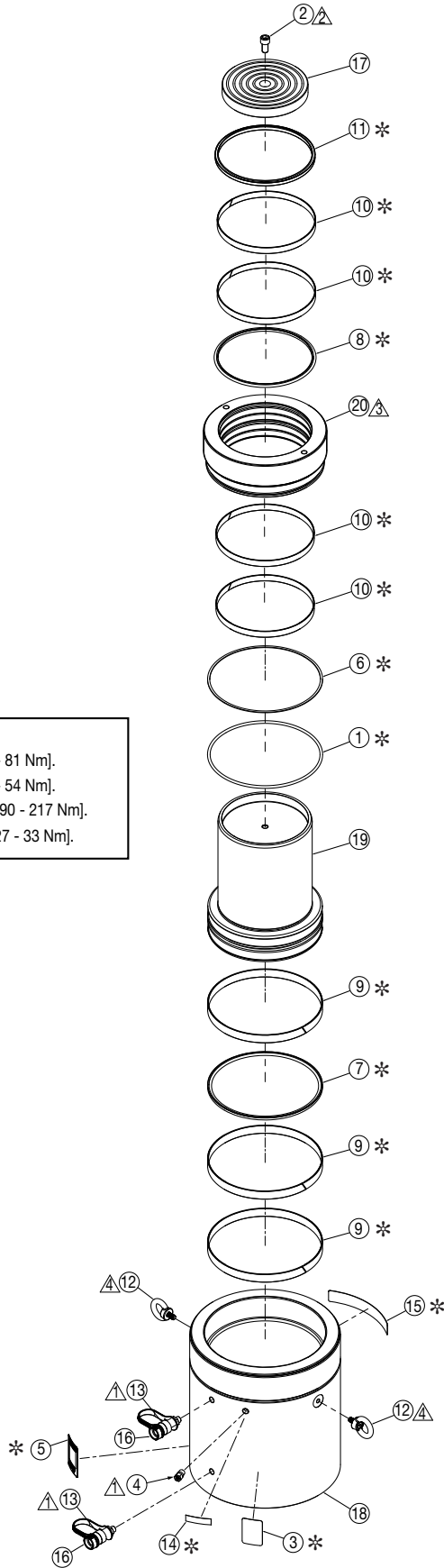

- Notes:**
- △1 Torque to 40 - 60 ft-lbs [55 - 81 Nm].
  - △2 Torque to 30 - 40 ft-lbs [41 - 54 Nm].
  - △3 Torque to 140 - 160 ft-lbs [190 - 217 Nm].
  - △4 Torque to 240 - 290 in-lbs [27 - 33 Nm].



**Repair Parts List for Figure 4**

<b>Item</b>	<b>Part Number</b>	<b>Qty.</b>	<b>Description</b>
1	* B1399503	1	O-Ring 417,96 x 7,00 Dash 462
2	CBE1625028-1A	1	Screw SHC M16 x 30 Zinc
3	* DA5625026	1	Warning Decal, 2.19" x 3.18"
4	DB8049900	1	Relief Valve Assembly
5	* DB8100026	1	Decal, Product Specification
6	* DB8139565	1	Back Up Ring 440 x 428,4 x 1,7
7	* DB8163076	1	Piston Seal 440 x 415,5 x 8,1
8	* DB8164076	1	Rod Seal 340 x 364 x 8,1
9	* DB8165155	3	Bearing, Piston 440 x 25
10	* DB8166155	4	Bearing, Rod 340 x 25
11	* DB8167776	1	Wiper 340 mm
12	DB8168667	2	Eyebolt, Rotating, M14
13	CR400	2	Female Coupler
14	* DC6154026	1	Decal, Safety Warning
15	* DC9596026	1	Decal, Enerpac
16	CD411D	2	Dust Cap
17	HCR1000045	1	Saddle HCR 1000 Ton
18	N/A	1	Base HCG/HCR 1000 Ton 50 mm
	N/A	1	Base HCG/HCR 1000 Ton 100 mm
	N/A	1	Base HCG/HCR 1000 Ton 150 mm
	N/A	1	Base HCG/HCR 1000 Ton 200 mm
	N/A	1	Base HCG/HCR 1000 Ton 250 mm
	N/A	1	Base HCG/HCR 1000 Ton 300 mm
19	HCR10002040	1	Plunger HCG/HCR 1000 Ton 50 mm
	HCR10004040	1	Plunger HCG/HCR 1000 Ton 100 mm
	HCR10006040	1	Plunger HCG/HCR 1000 Ton 150 mm
	HCR10008040	1	Plunger HCG/HCR 1000 Ton 200 mm
	HCR100010040	1	Plunger HCG/HCR 1000 Ton 250 mm
	HCR100012040	1	Plunger HCG/HCR 1000 Ton 300 mm
20	HCR10002044	1	Stop Ring HCR 1000 Ton

\* Included in HCR1000K Seal Kit. N/A - Not Available.

# NOTES:

A large rectangular box containing 20 horizontal lines, intended for writing notes.

# NOTES:

A large rectangular box containing 20 horizontal lines, intended for writing notes.

