

Document Number	Document Revision	Document Revision Date	Product Date Code Beginning With
L4250	B	07/2018	A

NOTICE:

Enerpac recommends the installation of all parts included in a service assembly or repair kit to ensure optimum performance of the repaired product.

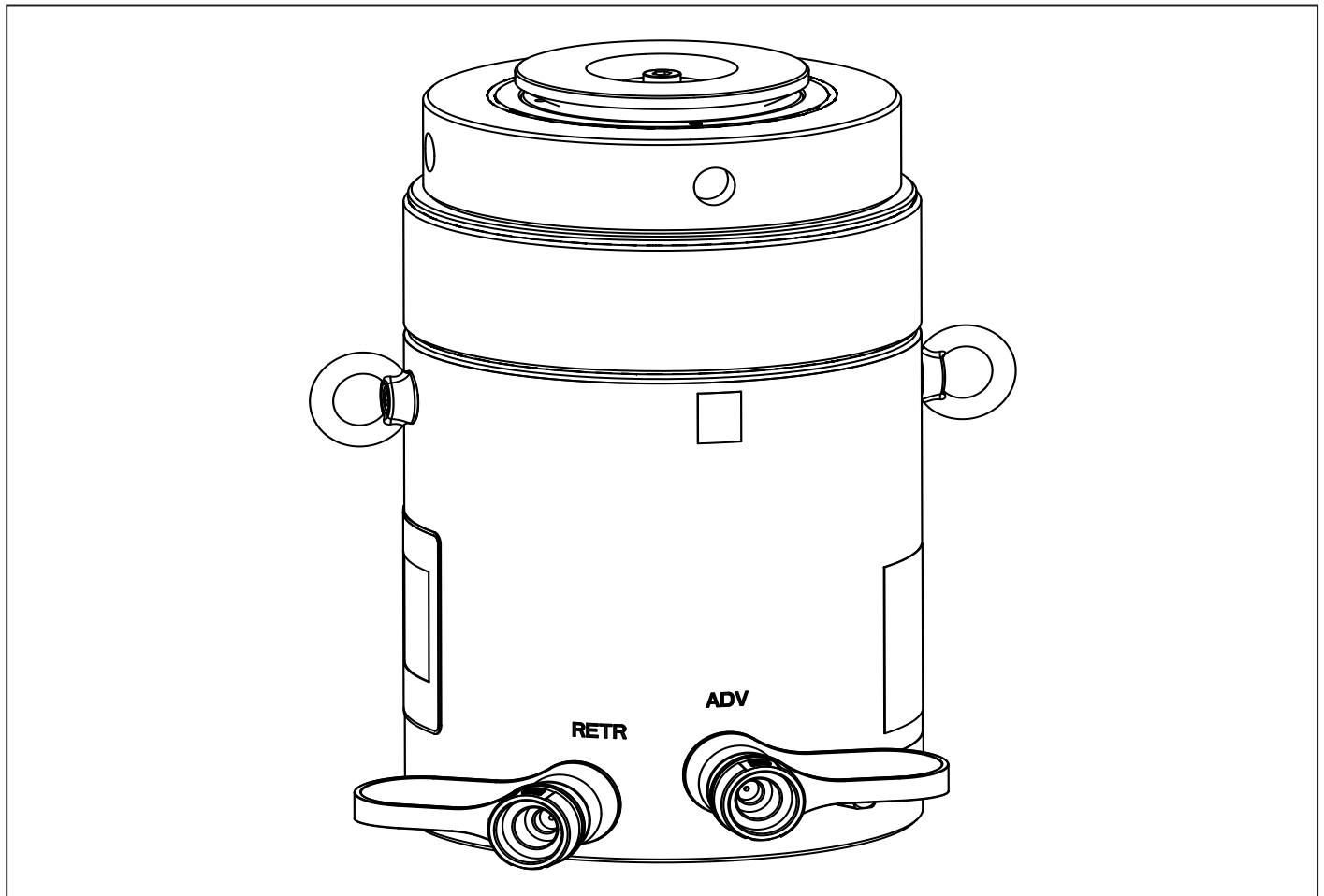
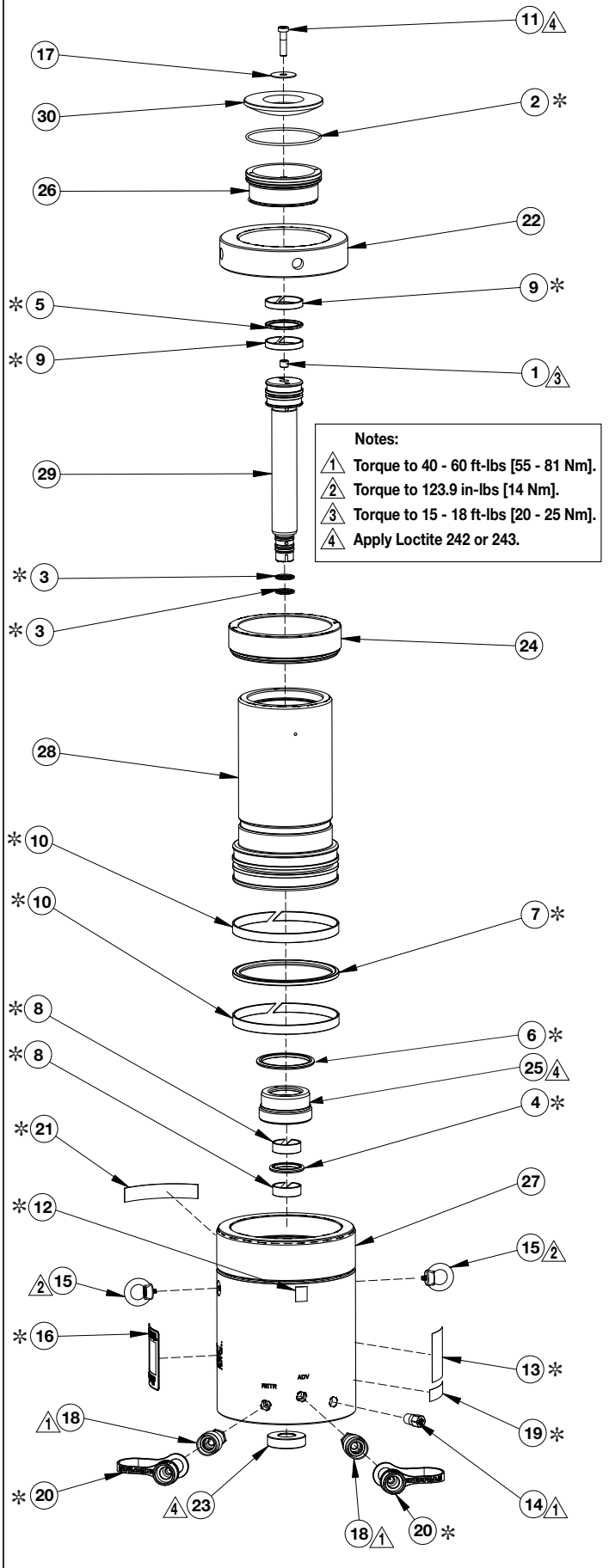

Table of Contents:

	Page		Page
Figure 1, Model HCRL-150 Short	2	Figure 2, Model HCRL-150 Tall	3

Figure 1, Exploded View - Model HCRL 1502-1506



Repair Parts List for Figure 1

Item	Part Number	Qty.	Description
1	A1008245	1	1/4 Flush Plug W/Sealant
2	* B1112503	1	O-Ring, OD:4.75, ID:4.50, W:1.125
3	* BA0030513	2	Piston Seal 30 x 22.5 x 3.2
4	* BA0040514	1	Rod Seal 40 x 55.1 x 6.3
5	* BA0060513	1	Piston Seal 60 x 49 x 4.2
6	* BA0085513	1	Piston Seal 85 x 69.5 x 6.3
7	* BA0170513	1	Piston Seal 170 x 149 x 8.1
8	* BAD0040141	2	Bearing 40 x 45 x 15
9	* BBC0060141	2	Bearing Piston 60 x 55 x 9.7
10	* BBD0170141	2	Bearing 170 x 165 x 15
11	CBA1029028-1D	1	Screw DIN 7984 M10 x 40 Low Head
12	* CU765026	1	Warning Decal, 0.75 x 0.94
13	* DA5625026	1	Warning Decal
14	DB8049900	1	Relief Valve Assembly
15	DB8099667	2	Eyebolt, Rotating, M6
16	* DB8100026	1	Decal, Product Specification
17	DB8108108	1	Washer, Steel 10.5 x 40 x 1.5 Zinc
18	DC1389900	2	Female Coupler
19	* DC6154026	1	Warning Decal
20	* DD1782020	2	Dust Cap
21	* DD2459026	1	Decal, Enerpac
22	HCRL150008	1	Nut HCRL 150
23	HCRL150008-1	1	Nut HCRL 150
24	HCRL150044	1	Stop Ring HCRL 150 Ton
25	HCRL150044-3	1	Stop Ring 150 Ton Small
26	HCRL150045-1	1	Tilt Saddle - Lower HCRL 150 Ton
27	N/A	1	Base HCRL 150 Ton 50 mm
	N/A	1	Base HCRL 150 Ton 100 mm
	N/A	1	Base HCRL 150 Ton 150 mm
28	N/A	1	Plunger HCRL 150 Ton 50 mm
	N/A	1	Plunger HCRL 150 Ton 100 mm
	N/A	1	Plunger HCRL 150 Ton 150 mm
29	N/A	1	Plunger-Int HCRL 150 Ton 50 mm
	N/A	1	Plunger-Int HCRL 150 Ton 100 mm
	N/A	1	Plunger-Int HCRL 150 Ton 150 mm
30	LPL100045	1	Saddle LPL100

* Included in HCRL1502K Repair Kit. N/A - Item not available.

Figure 2, Exploded View - Model HCRL 1508-15012

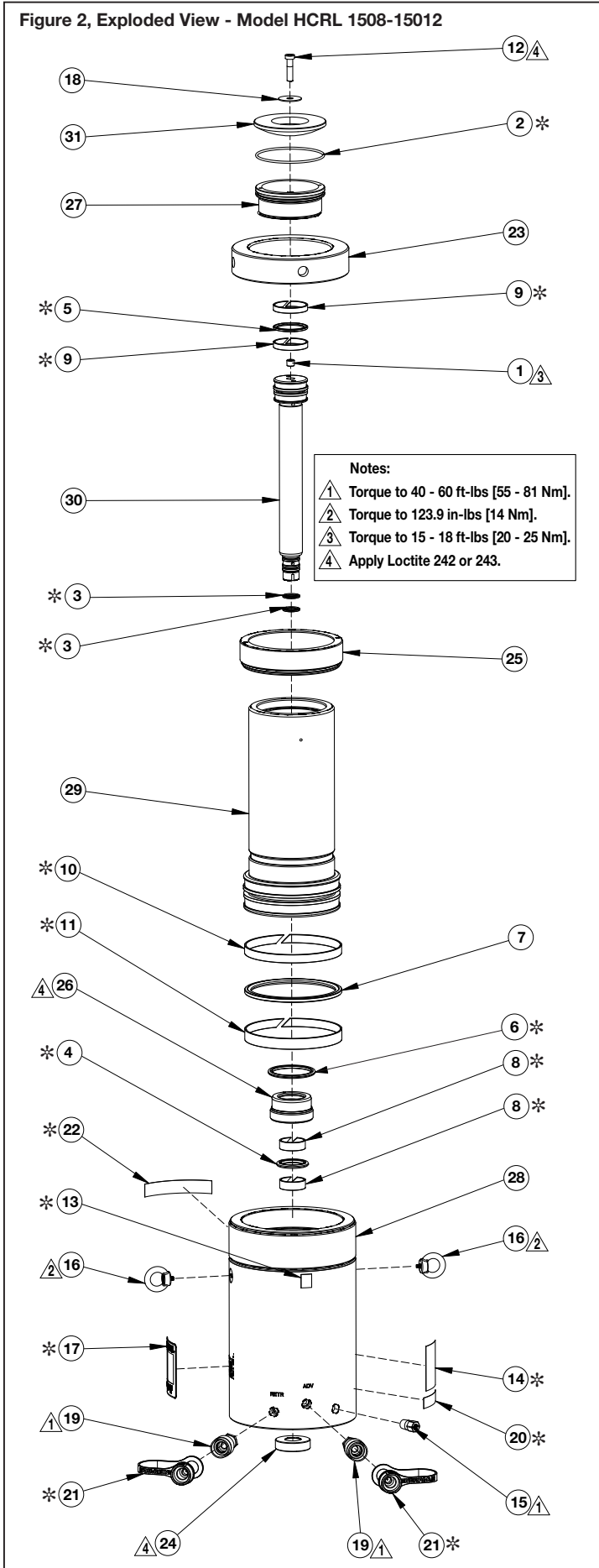

Repair Parts List for Figure 2

Item	Part Number	Qty.	Description
1	A1008245	1	1/4 Flush Plug W/Sealant
2	* B1112503	1	O-Ring, OD:4.75, ID:4.50, W:1.125
3	* BA0030513	2	Piston Seal 30 x 22.5 x 3.2
4	* BA0040514	1	Rod Seal 40 x 55.1 x 6.3
5	* BA0060513	1	Piston Seal 60 x 49 x 4.2
6	* BA0085513	1	Piston Seal 85 x 69.5 x 6.3
7	* BA0170513	1	Piston Seal 170 x 149 x 8.1
8	* BAE0040141	2	Bearing 40 x 45 x 25
9	* BBC0060141	2	Bearing Piston 60 x 55 x 9.7
10	* BBD0170141	1	Bearing 170 x 165 x 15
11	* BBE0170141	1	Bearing 170 x 165 x 25
12	CBA1029028-1D	1	Screw DIN 7984 M10 x 40 Low Head
13	* CU765026	1	Warning Decal, 0.75 x 0.94
14	* DA5625026	1	Warning Decal
15	DB8049900	1	Relief Valve Assembly
16	DB8099667	2	Eyebolt, Rotating, M6
17	* DB8100026	1	Decal, Product Specification
18	DB8108108	1	Washer, Steel 10.5 x 40 x 1.5 Zinc
19	DC1389900	2	Female Coupler
20	* DC6154026	1	Warning Decal
21	* DD1782020	2	Dust Cap
22	* DD2459026	1	Decal, Enerpac
23	HCRL150008	1	Nut HCRL 150
24	HCRL150008-1	1	Nut HCRL 150
25	HCRL150044-1	1	Stop Ring HCRL 150 Ton
26	HCRL150044-2	1	Stop Ring 150 Ton
27	HCRL150045-1	1	Tilt Saddle - Lower HCRL 150 Ton
28	N/A	1	Base HCRL 150 Ton 200 mm
	N/A	1	Base HCRL 150 Ton 250 mm
	N/A	1	Base HCRL 150 Ton 300 mm
29	N/A	1	Plunger HCRL 150 Ton 200 mm
	N/A	1	Plunger HCRL 150 Ton 250 mm
	N/A	1	Plunger HCRL 150 Ton 300 mm
30	N/A	1	Plunger-Int HCRL 150 Ton 200 mm
	N/A	1	Plunger-Int HCRL 150 Ton 250 mm
	N/A	1	Plunger-Int HCRL 100 Ton 300 mm
31	LPL100045	1	Saddle LPL100

* Included in HCRL1508K Repair Kit. N/A - Item not available.

