

Document Number	Document Revision	Document Revision Date	Product Date Code Beginning With
L4251	C	07/2018	A

NOTICE:

Enerpac recommends the installation of all parts included in a service assembly or repair kit to ensure optimum performance of the repaired product.

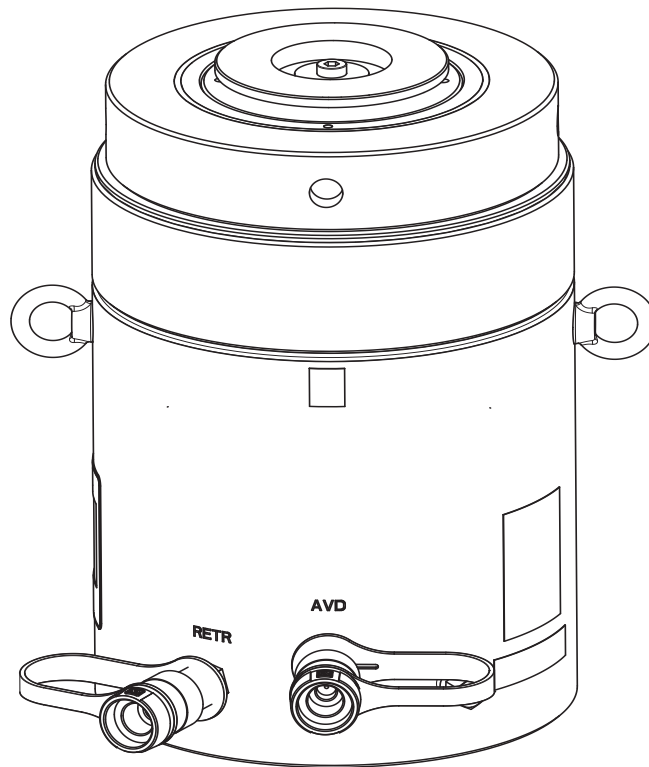
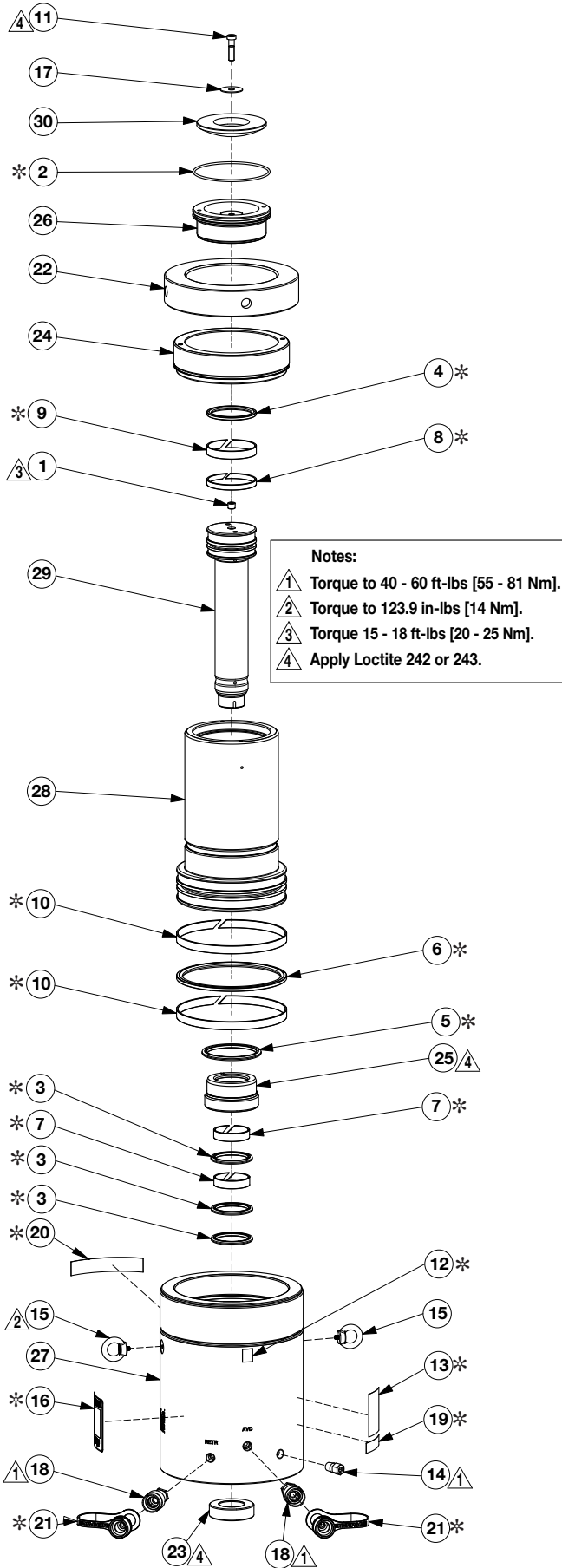

Table of Contents:

	Page	Page	
Figure 1, Model HCRL-200 Short	2	Figure 2, Model HCRL-200 Tall	3

Figure 1, Exploded View - Model HCRL 2002-2006



Repair Parts List for Figure 1

Item	Part Number	Qty.	Description
1	A1008245	1	1/4 Flush Plug W/Sealant
2	* B1118503	1	O-Ring
3	* BA0060514	3	Rod Seal 60 x 75.1 x 6.3
4	* BA0090513	1	Piston Seal 90 x 74.5 x 6.3
5	* BA0115513	1	Piston Seal 115 x 99.5 x 6.3
6	* BA0200513	1	Piston Seal 200 x 179 x 8.1
7	* BAD0060141	2	Bearing 60 x 65 x15
8	* BBC0090141	1	Bearing 90 x 85 x 9.7
9	* BBD0090141	1	Bearing 90 x 85 x 15
10	* BBD0200141	2	Bearing 200 x 195 x 15
11	CBA1029028-1D	1	Screw DIN 7984 M10 x 40 Low Head
12	* CU765026	1	Warning Decal 0.75 x 0.94
13	* DA5625026	1	Warning Decal
14	DB8049900	1	Relief Valve Assembly
15	DB8099667	2	Eyebolt, Rotating, M6
16	* DB8100026	1	Decal, Product Specification
17	DB8108108	1	Washer, Steel 10.5 x 40 x 1.5 Zinc
18	DC1389900	2	Female Coupler
19	* DC6154026	1	Warning Decal
20	* DD1042026	1	Enerpac Decal
21	* DD1782020	2	Dust Cap
22	HCRL200008	1	Nut HCRL 200
23	HCRL200008-1	1	Nut HCRL 200
24	HCRL200044	1	Stop Ring HCRL 200 Ton
25	HCRL200044-3	1	Stop Ring HCRL Small
26	HCRL200045-1	1	Tilt Saddle - Lower HCRL 200 Ton
27	N/A	1	Base HCRL 200 Ton 50 mm
	N/A	1	Base HCRL 200 Ton 100 mm
	N/A	1	Base HCRL 200 Ton 150 mm
28	N/A	1	Plunger HCRL 200 Ton 50 mm
	N/A	1	Plunger HCRL 200 Ton 100 mm
	N/A	1	Plunger HCRL 200 Ton 150 mm
29	N/A	1	Plunger-Int HCRL 200 Ton 50 mm
	N/A	1	Plunger-Int HCRL 200 Ton 100 mm
	N/A	1	Plunger-Int HCRL 200 Ton 150 mm
30	LPL100045	1	Saddle LPL100

* Included in HCRL2002K Repair Kit. N/A - Item not available.

Figure 2, Exploded View - Model HCRL 2008-2012

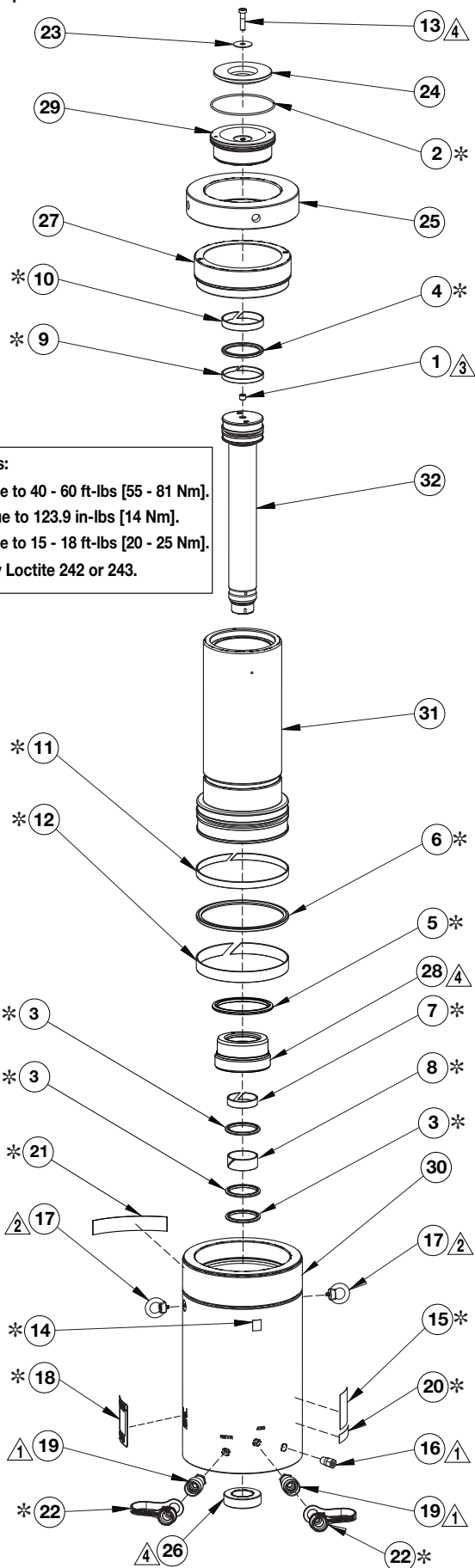

Notes:
 ⚠ Torque to 40 - 60 ft-lbs [55 - 81 Nm].
 ⚠ Torque to 123.9 in-lbs [14 Nm].
 ⚠ Torque to 15 - 18 ft-lbs [20 - 25 Nm].
 ⚠ Apply Loctite 242 or 243.

Repair Parts List for Figure 2

Item	Part Number	Qty.	Description
1	A1008245	1	1/4 Flush Plug W/Sealant
2	* B1118503	1	O-Ring
3	* BA0060514	3	Rod Seal 60 x 75.1 x 6.3
4	* BA0090513	1	Piston Seal 90 x 74.5 x 6.3
5	* BA0115513	1	Piston Seal 115 x 99.5 x 6.3
6	* BA0200513	1	Piston Seal 200 x 179 x 8.1
7	* BAD0060141	1	Bearing 60 x 65 x15
8	* BAE0060141	1	Bearing 60 x 65 x25
9	* BBC0090141	1	Bearing 90 x 85 x 9.7
10	* BBD0090141	1	Bearing 90 x 85 x 15
11	* BBD0200141	1	Bearing 200 x 195 x 15
12	* BBE0200141	1	Bearing 200 x 195 x 25
13	CBA1029028-1D	1	Screw DIN 7984 M10 x 40 Low Head
14	* CU765026	1	Warning Decal 0.75 x 0.94
15	* DA5625026	1	Warning Decal
16	DB8049900	1	Relief Valve Assembly
17	DB8099667	2	Eyebolt, Rotating, M6
18	* DB8100026	1	Decal, Product Specification
19	DC1389900	2	Female Coupler
20	* DC6154026	1	Warning Decal
21	* DD1042026	1	Decal, Enerpac
22	* DD1782020	2	Dust Cap
23	DB8108108	1	Washer Steel 10.5 x 40 x 1.5 Zinc
24	LPL100045	1	Saddle LPL100
25	HCRL200008	1	Nut HCRL 200
26	HCRL200008-1	1	Nut HCRL 200
27	HCRL200044-1	1	Stop Ring HCRL 200 Ton
28	HCRL200044-2	1	Stop Ring HCRL 200 Ton
29	HCRL200045-1	1	Tilt Saddle - Lower HCRL 200 Ton
30	N/A	1	Base HCRL 200 Ton 200mm
	N/A	1	Base HCRL 200 Ton 250mm
	N/A	1	Base HCRL 200 Ton 300mm
31	N/A	1	Plunger HCRL 200 Ton 200mm
	N/A	1	Plunger HCRL 200 Ton 250mm
	N/A	1	Plunger HCRL 200 Ton 300mm
32	N/A	1	Plunger-Int HCRL 200 Ton 200mm
	N/A	1	Plunger-Int HCRL 200 Ton 250mm
	N/A	1	Plunger-Int HCRL 200 Ton 300mm

* Included in HCRL2008K Repair Kit. N/A - Item not available.

