

Document Number	Document Revision	Document Revision Date	Product Date Code Beginning With
L4202	B	11/2017	A

NOTICE:

Enerpac recommends the installation of all parts included in a service assembly or repair kit to ensure optimum performance of the repaired product.

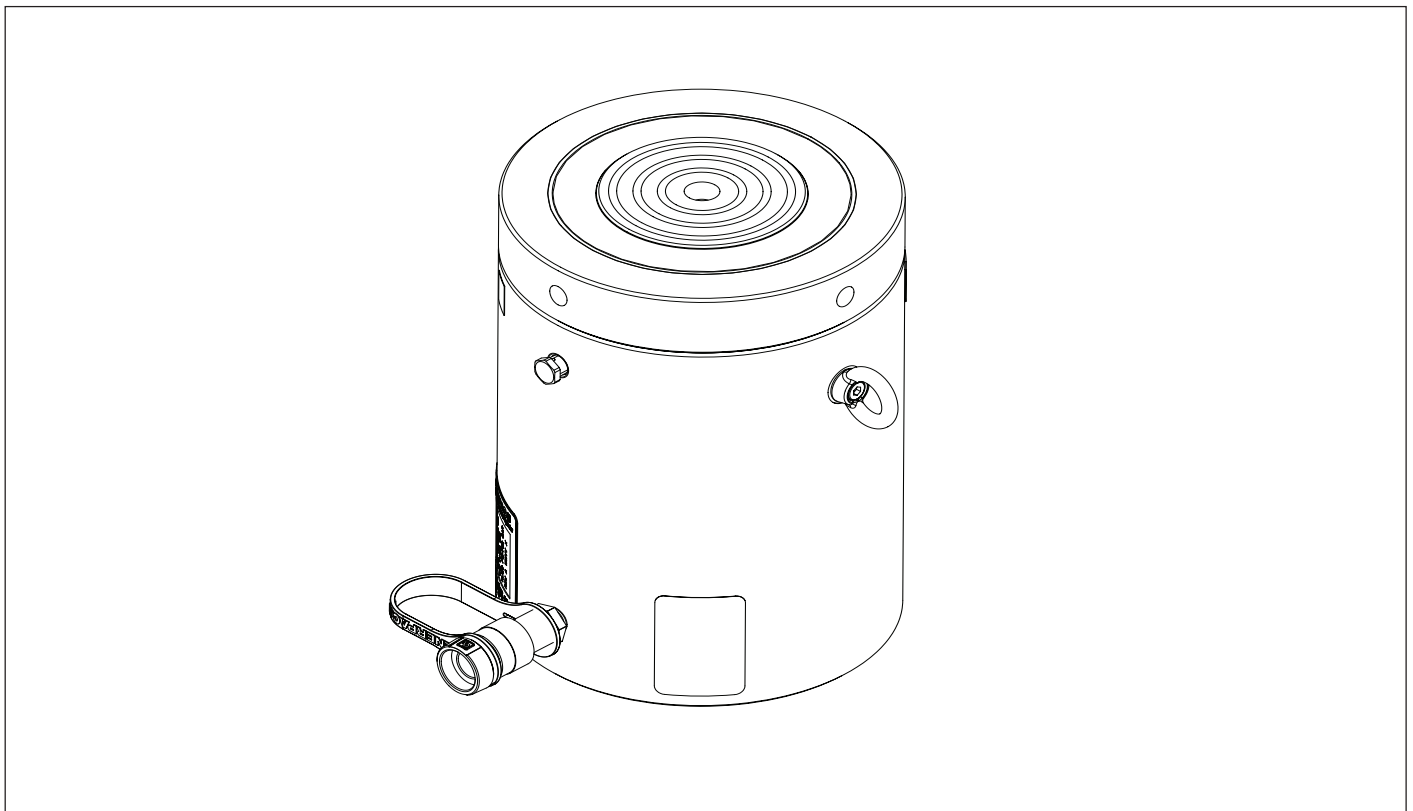
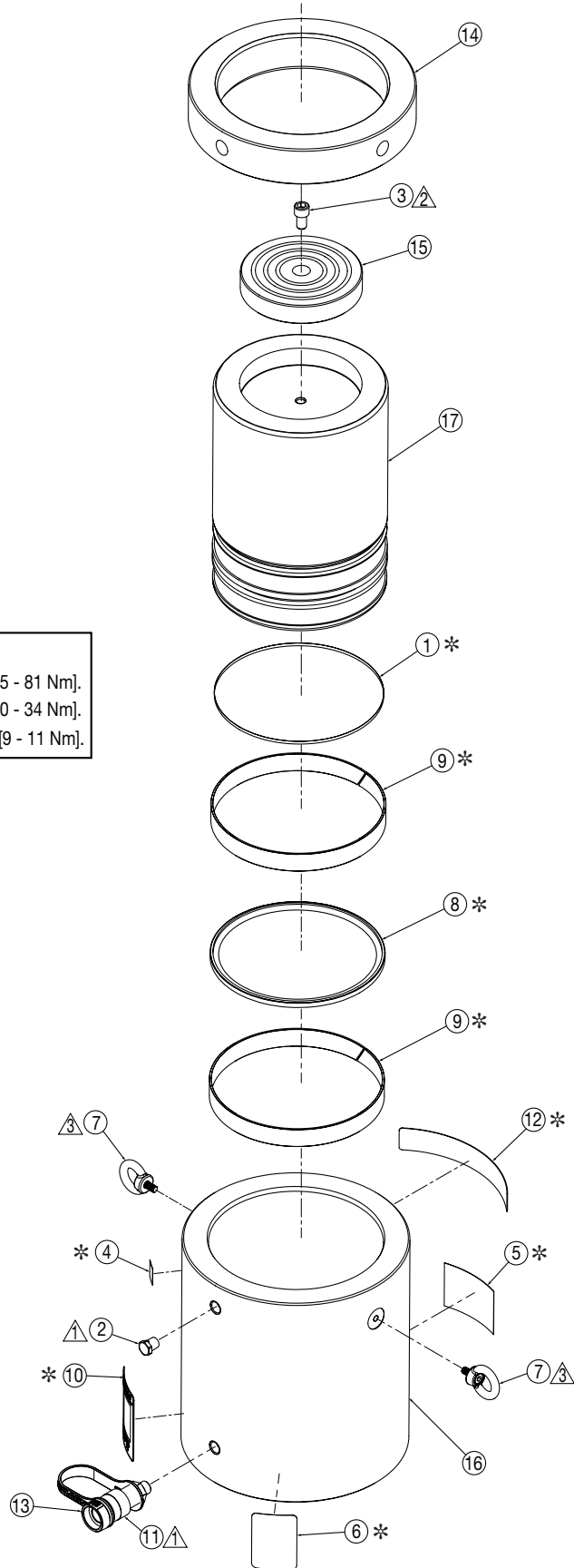

Table of Contents:

	Page		Page
Figure 1, Model HCL-250	2-3	Figure 3, Model HCL-400	6-7
Figure 2, Model HCL-300	4-5	Figure 4, Model HCL-500	8-9

Figure 1, Exploded View - Model HCL-250

NOTES:
 ▲ Torque to 40 - 60 ft-lbs [55 - 81 Nm].
 ▲ Torque to 15 - 25 ft-lbs [20 - 34 Nm].
 ▲ Torque to 80 - 100 in-lbs [9 - 11 Nm].



Repair Parts List for Figure 1

Item	Part Number	Qty.	Description
1	* BSS5145D	26.75"	Strip, Red 1/4" Wide
2	BSS6349D	1	Plug
3	CBE1221028-1A	1	M12 x 20 Long SHCS
4	* CU765026	1	Warning Decal, 0.75" x 0.94"
5	* DA3128026	1	Plunger Caution Warning Decal
6	* DA5625026	1	Warning Decal, 2.19" x 3.18"
7	DB8050667	2	Eyebolt, Rotating, M8
8	* DB8079076	1	Piston Seal 215 x 194 x 8,1
9	* DB8087155	2	Bearing, Piston 215 x 25
10	* DB8100026	1	Decal, Product Specification
11	CR400	1	Female Coupler
12	* DD1042026	1	Decal, Enerpac
13	CD411D	1	Dust Cap
14	HCL250008	1	Lock Nut HCL 250 Ton
15	HCL250045	1	Saddle HCL 250 Ton
16	N/A	1	Base HCL 250 Ton 50 mm
	N/A	1	Base HCL 250 Ton 100 mm
	N/A	1	Base HCL 250 Ton 150 mm
	N/A	1	Base HCL 250 Ton 200 mm
	N/A	1	Base HCL 250 Ton 250 mm
	N/A	1	Base HCL 250 Ton 300 mm
17	HCL2502040	1	Plunger HCL 250 Ton 50 mm
	HCL2504040	1	Plunger HCL 250 Ton 100 mm
	HCL2506040	1	Plunger HCL 250 Ton 150 mm
	HCL2508040	1	Plunger HCL 250 Ton 200 mm
	HCL25010040	1	Plunger HCL 250 Ton 250 mm
	HCL25012040	1	Plunger HCL 250 Ton 300 mm
* Included in HCL250K Seal Kit. N/A - Not Available.			

Figure 2, Exploded View - Model HCL-300

NOTES:
 ▲ Torque to 40 - 60 ft-lbs [55 - 81 Nm].
 ▲ Torque to 30 - 40 ft-lbs [41 - 54 Nm].
 ▲ Torque to 80 - 100 in-lbs [9 - 11 Nm].

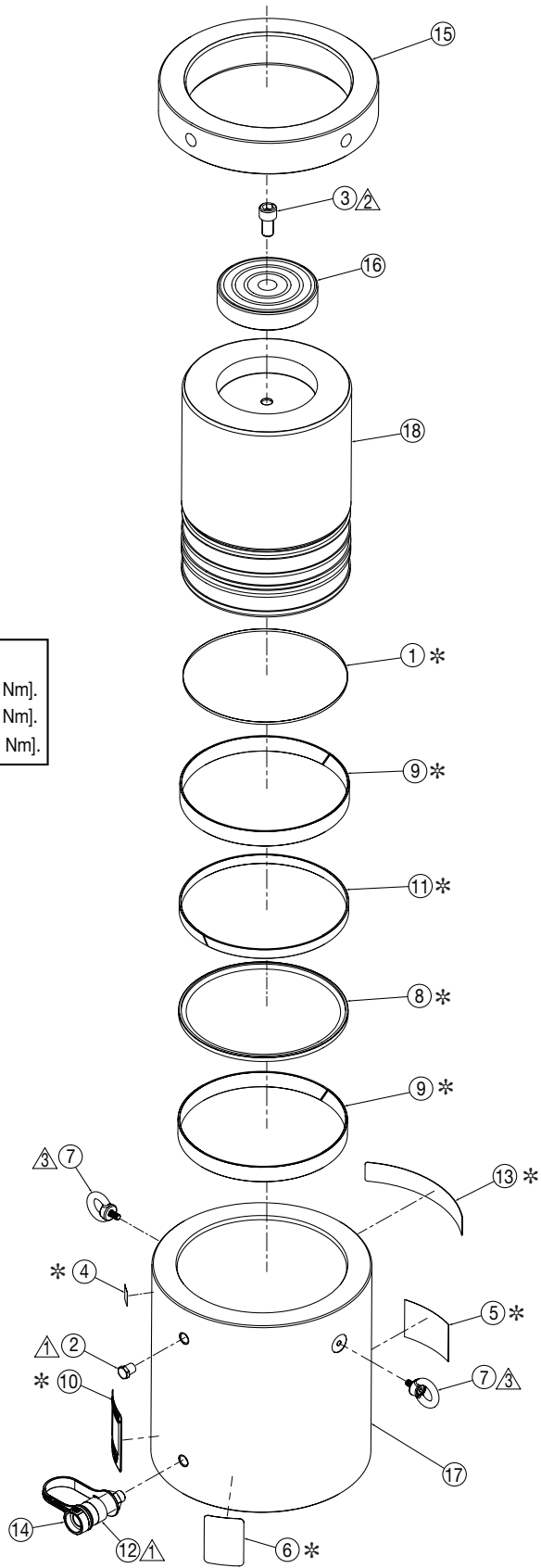

Repair Parts List for Figure 2

Item	Part Number	Qty.	Description
1	* BSS5145D	30"	Strip, Red 1/4" Wide
2	BSS6349D	1	Plug
3	CBE1625028-1A	1	Screw, SHC M16 x 30 Zinc
4	* CU765026	1	Warning Decal, 0.75" x 0.94"
5	* DA3128026	1	Plunger Caution Warning Decal
6	* DA5625026	1	Warning Decal, 2.19" x 3.18"
7	DB8050667	2	Eyebolt, Rotating, M8
8	* DB8089076	1	Piston Seal 235 x 214 x 8,1
9	* DB8091155	2	Bearing, Piston 235 x 25
10	* DB8100026	1	Decal, Product Specification
11	* DB8171155	1	Bearing, Piston 235 x 25
12	CR400	1	Female Coupler
13	* DD1042026	1	Decal, Enerpac
14	CD411D	1	Dust Cap
15	HCL300008	1	Lock Nut HCL 300 Ton
16	HCL300045	1	Saddle HCL 300 Ton
17	N/A	1	Base HCL 300 Ton 50 mm
	N/A	1	Base HCL 300 Ton 100 mm
	N/A	1	Base HCL 300 Ton 150 mm
	N/A	1	Base HCL 300 Ton 200 mm
	N/A	1	Base HCL 300 Ton 250 mm
	N/A	1	Base HCL 300 Ton 300 mm
18	HCL3002040	1	Plunger HCL 300 Ton 50 mm
	HCL3004040	1	Plunger HCL 300 Ton 100 mm
	HCL3006040	1	Plunger HCL 300 Ton 150 mm
	HCL3008040	1	Plunger HCL 300 Ton 200 mm
	HCL30010040	1	Plunger HCL 300 Ton 250 mm
	HCL30012040	1	Plunger HCL 300 Ton 300 mm

*Included in HCL300K Seal Kit. N/A - Not Available.

Figure 3, Exploded View - Model HCL-400

NOTES:
 ▲ Torque to 40 - 60 ft-lbs [55 - 81 Nm].
 ▲ Torque to 30 - 40 ft-lbs [41 - 54 Nm].
 ▲ Torque to 200 - 240 in-lbs [23 - 27 Nm].

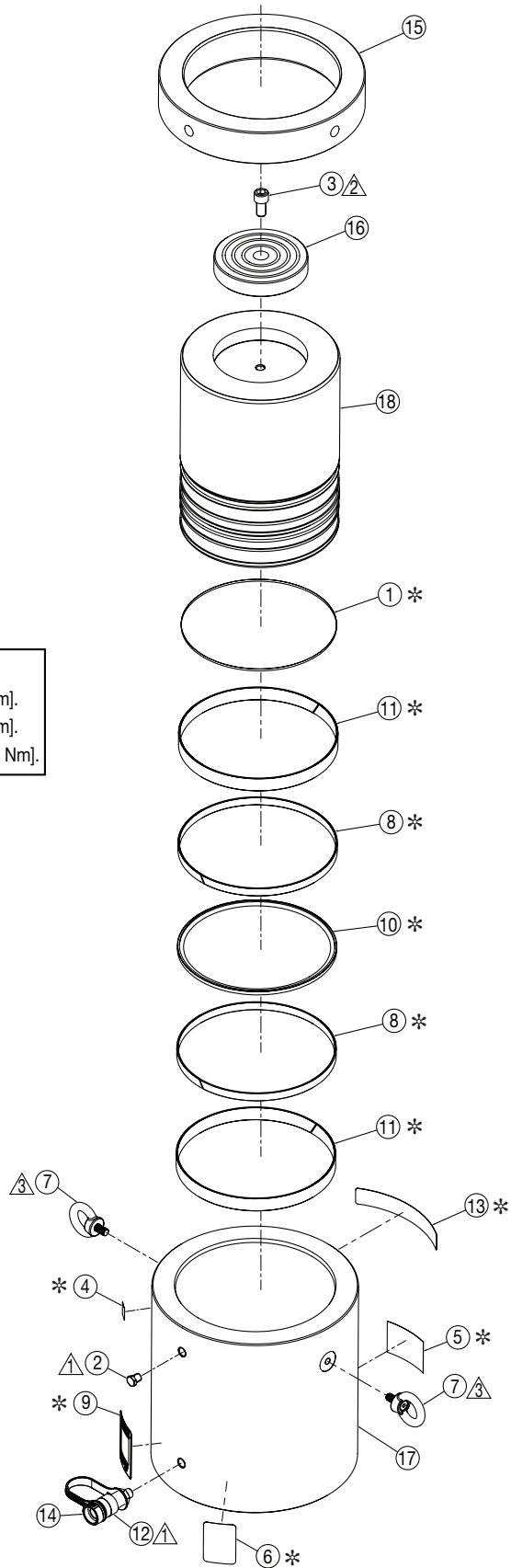

Repair Parts List for Figure 3

Item	Part Number	Qty.	Description
1	* BSS5145D	32.5"	Strip, Red 1/4" Wide
2	BSS6349D	1	Plug
3	CBE1625028-1A	1	Screw, SHC M16 x 30 Zinc
4	* CU765026	1	Warning Decal, 0.75" x 0.94"
5	* DA3128026	1	Plunger Caution Warning Decal
6	* DA5625026	1	Warning Decal, 2.19" x 3.18"
7	DB8086667	2	Eyebolt, Rotating, M12
8	* DB8098155	2	Bearing, Piston 270 x 15
9	* DB8100026	1	Decal, Product Specification
10	* DB8140076	1	Piston Seal 270 x 249 x 8,1
11	* DB8142155	2	Bearing, Piston 270 x 25
12	CR400	1	Female Coupler
13	* DD1042026	1	Decal, Enerpac
14	CD411D	1	Dust Cap
15	HCL400008	1	Lock Nut HCL 400 Ton
16	HCL400045	1	Saddle HCL 400 Ton
17	N/A	1	Base HCL 400 Ton 50 mm
	N/A	1	Base HCL 400 Ton 100 mm
	N/A	1	Base HCL 400 Ton 150 mm
	N/A	1	Base HCL 400 Ton 200 mm
	N/A	1	Base HCL 400 Ton 250 mm
	N/A	1	Base HCL 400 Ton 300 mm
18	HCL4002040	1	Plunger HCL 400 Ton 50 mm
	HCL4004040	1	Plunger HCL 400 Ton 100 mm
	HCL4006040	1	Plunger HCL 400 Ton 150 mm
	HCL4008040	1	Plunger HCL 400 Ton 200 mm
	HCL40010040	1	Plunger HCL 400 Ton 250 mm
	HCL40012040	1	Plunger HCL 400 Ton 300 mm

* Included in HCL400K Seal Kit. N/A - Not Available.

Figure 4, Exploded View - Model HCL-500

NOTES:
 ▲ Torque to 40 - 60 ft-lbs [55 - 81 Nm].
 ▲ Torque to 30 - 40 ft-lbs [41 - 54 Nm].
 ▲ Torque to 200 - 240 in-lbs [23 - 27 Nm].

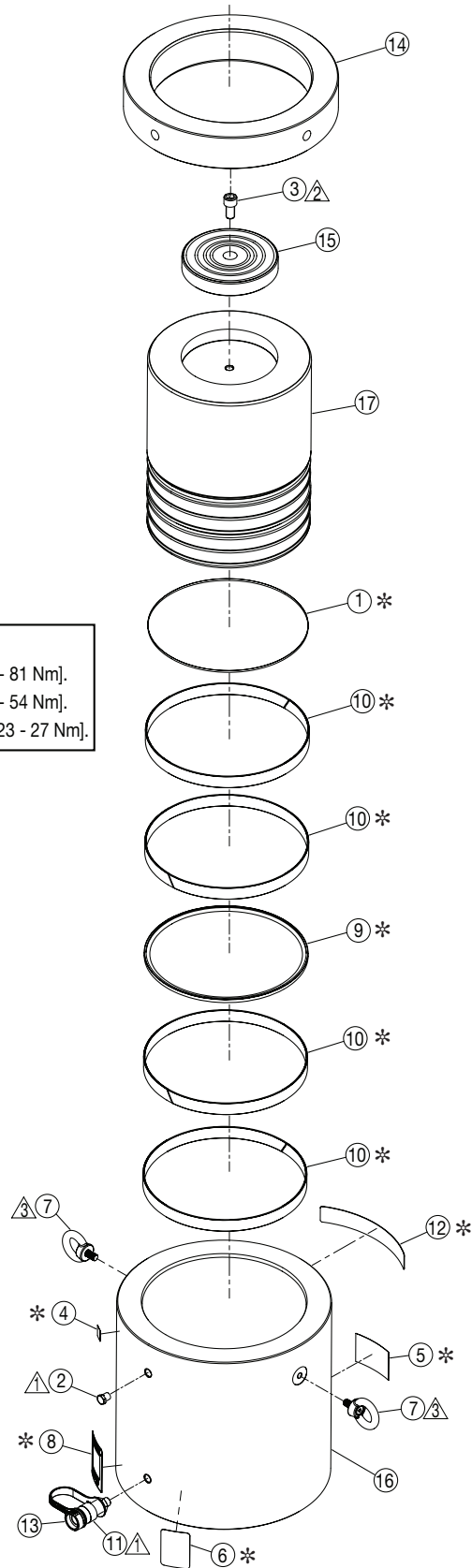

Repair Parts List for Figure 4

Item	Part Number	Qty.	Description
1	* BSS5145D	36.75"	Strip, Red 1/4" Wide
2	BSS6349D	1	Plug
3	CBE1625028-1A	1	Screw, SHC M16 x 30 Zinc
4	* CU765026	1	Warning Decal, 0.75" x 0.94"
5	* DA3128026	1	Plunger Caution Warning Decal
6	* DA5625026	1	Warning Decal, 2.19" x 3.18"
7	DB8086667	2	Eyebolt, Rotating, M12
8	* DB8100026	1	Decal, Product Specification
9	* DB8146076	1	Piston Seal 305 x 284 x 8,1
10	* DB8148155	4	Bearing, Piston 305 x 25
11	CR400	1	Female Coupler
12	* DC9596026	1	Decal, Enerpac
13	CD411D	1	Dust Cap
14	HCL500008	1	Lock Nut HCL 500 Ton
15	HCL500045	1	Saddle HCL 500 Ton
16	N/A	1	Base HCL 500 Ton 50 mm
	N/A	1	Base HCL 500 Ton 100 mm
	N/A	1	Base HCL 500 Ton 150 mm
	N/A	1	Base HCL 500 Ton 200 mm
	N/A	1	Base HCL 500 Ton 250 mm
	N/A	1	Base HCL 500 Ton 300 mm
17	HCL5002040	1	Plunger HCL 500 Ton 50 mm
	HCL5004040	1	Plunger HCL 500 Ton 100 mm
	HCL5006040	1	Plunger HCL 500 Ton 150 mm
	HCL5008040	1	Plunger HCL 500 Ton 200 mm
	HCL50010040	1	Plunger HCL 500 Ton 250 mm
	HCL50012040	1	Plunger HCL 500 Ton 300 mm
*Included in HCL500K Seal Kit. N/A - Not Available.			

